



CONFERENCE SCHEDULE BOOK



3RD INTERNATIONAL CONFERENCE ON PUBLIC HEALTH

**27th - 29th July 2017
Kuala Lumpur, Malaysia**

**Power is gained by
SHARING KNOWLEDGE**



**Present | Network
Publish | Contribute**



www.tiikm.com

Message from the Conference Convener – ICOPH 2017



Mr. Isanka P. Gamage

It is with great pleasure that I pen down a few words for the 03rd International Conference on Public Health (ICOPH 2017) which is held from 27-29 July, 2017 in Kuala Lumpur, Malaysia. I use this opportunity to welcome all the participants to this great knowledge platform, who are from countries across the world representing the field of Medicine and Public Health.

We, as the International Institute of Knowledge Management (TIKM), strive to take the next advanced step in empowering research all around the world carried out under different scopes. This is by means of hosting international conferences, opening up publication spaces and creating the academia – corporate cohesiveness maintaining the utmost quality levels while going for creative innovations based on technology. ICOPH 2017, which is our successful 03rd consecutive conference in this scope, is also such an attempt that we have taken with the aim of a better tomorrow for everyone in the world. Based on the industry principles, and also considering the suggestions by the past participants of the conferences, this year we have introduced several novel items to the program of ICOPH 2017 such as the Students' Gathering, Round Table Discussions, Networking Dinners, Conference Chair Workshops and many more, which we believe will be of best use for the purposes of sharing more knowledge, more networking and also much enriched entertainment. I also use this opportunity to invite all of you to join with these features as well in the days to come ahead.

Once again, Thank you all for being here at ICOPH 2017, and we hope you will go along the path of ICOPH with us by taking part in ICOPH 2018 as well which will be held from 21-23 July, 2018 in Bangkok, Thailand.

Thank You. Enjoy the ICOPH 2017 experience.



Contents

Message from the Conference Convener – ICOPH 2017

Key Personnel

4 Days at a Glance

Session Key Icons

Conference Floor Plan

Day I – Program

Day II – Program

Day III – Program

Post Conference Tour

Special Information

Conference Key Personnel

Conference Co-chairs



Professor Dr. Hematram Yadav
Department of Community Medicine
MAHSA University



Prof. Dr. Rusli Bin Nordin
Professor of Public Health Medicine
(occupational health)
Clinical School Johor Bahru
Jeffrey Cheah School of Medicine and
Health Sciences, Monash University Malaysia

Keynote speakers



Datuk Dr Noor Hisham Abdullah
Director-General of Health Malaysia &
Senior Consultant in Breast & Endocrine
Surgery



Prof. David C. Bellinger
Professor in the Department of Environmental
Health Harvard T. H. Chan School of Public
Health, USA

Plenary speakers



Prof. Dr. Forhad Akhtar Zaman
Department of Community Medicine
Sikkim Manipal Institute of Medical
Sciences, India



Prof. Kumudu Wijewardene
Senior Professor of Community Medicine
Faculty of Medicine, University of
Sri Jayewardenepura Sri Lanka

Sessions Chair

Prof. Dr. Rusli Bin Nordin
Monash University, Malaysia

Dr. Umesh Bindal
Taylor's University, Malaysia

Dr. Prabal Bhargava
Taylor's University, Malaysia

Dr. Mohammad Jaweed
Taylor's University, Malaysia

Dr. Gul Baloch
Taylor's University, Malaysia

Assoc. Prof. Nurjahan Mohd Ibrahim
Taylor's University, Malaysia

Dr. Rekha Probhu
Taylor's University, Malaysia

Dr. Binu Upreti
Sikkim Manipal Institute of Medical Sciences, India

Assoc. Prof. Abdul Kareem Meera Mohaideen
Taylor's University, Malaysia

Dr. Girish Prabhu
Taylor's University, Malaysia

Prof. Dr. Hematram Yadav
Mahsa University, Malaysia

Prof. Dr. Hari Kumar Darnal
Mahsa University, Malaysia

Prof. Kumudu Wijewardene
University of Sri Jayewardenepura, Sri Lanka

Prof. Dr. Vijay Kumar Mehta
Sikkim Manipal University, India

Dr. Mohd Hafiz Jaafar
Universiti Sains Islam Malaysia, Malaysia

Dr. Zeynep Kirdi Harbawi
Istanbul University, Turkey

4 DAY SCHEDULE AT A GLANCE

THURSDAY – 27TH JULY

- 07.00 – 08.45 – Registrations
- 09.00 – 09.45 – Inauguration ceremony
- 09.45 – 10.30 – Conference Photograph & Morning Refreshments
- 10.30 – 11.15 – Keynote Speech
- 11.20 – 12.20 – Publication Workshop
- 12.30 – 13.20 – Networking lunch
- 13.20 – 15.08 – Technical Sessions 1, 2, 3, 4 and 5 (concurrent)
- 15.08 – 15.25 – Evening Refreshments
- 15.25 – 17.13 – Technical Sessions 6, 7, 8, 9 and 10 (concurrent)
- 17.20 – 18.20 – Round Table Discussion
- 19.00 Onwards – Cultural Show + Dinner

FRIDAY - 28TH JULY

- 08.30 Onwards – Poster Sessions
- 09.00 – 10.30 – Technical Sessions 11, 12, 13 and 14 (concurrent)
- 10.30 – 10.45 – Morning Refreshments
- 10.45 – 11.30 – Keynote Speech
- 11.35 – 13.05 – Technical Sessions 15, 16, 17 and 18 (concurrent)
- 13.10 – 14.00 – Lunch
- 14.10 – 16.20 – Technical Sessions 19, 20, 21 and 22 (concurrent)
- 14.30 – 15.40 – Evaluation Poster Sessions 1 & 2
- 16.20 – 16.35 – Evening Refreshments
- 16.35 – 17.50 – Technical Sessions 23, 24, 25 and 26 (concurrent)
- 16.45 – 17.55 – Evaluation Poster Sessions 3 & 4
- 18.00 – 19.00 – Students' Gathering

SATURDAY - 29TH JULY

- 09.00 – 10.30 – Technical Sessions 27, 28, 29, 30 and 31 (concurrent)
- 10.30 – 10.50 – Morning Refreshments
- 10.50 – 12.40 – Technical Sessions 32, 33, 34, 35 and 36 (concurrent)
- 12.40 – 13.10 – Conference Chair Workshop
- 13.10 – 13.30 – Conference Closure & Awarding Ceremony
- 13.30 Onwards – Networking Lunch

SUNDAY - 30TH JULY

08.30 – 16.30
Post Conference Tour (Optional)

SESSIONKEY ICONS



Occupational
and
Environmental health
(A)



Child health
(B)



Health care
systems
(C)



Infectious
diseases
(D)



Preventive
health
(E)



Maternal
health
(F)



Smoking
alcohol and
health
(G)



Nutrition
(H)



School and
Student
health
(K)



Mental health
(M)



Primary
health care (J)



Health
Promotion,
Education and
Hospital
Management
(N)



Adolescent &
Young Adults
Health
(T)



Metabolic
syndrome
(R)



Oral Health
and Pharmacy
(Q)



Clinical
Medicine
(Y)



Sociology and
Health
(V)



Young Adults
and Elderly
(Z)

THE LATITUDE, LEVEL 3

Remarks: plan is not to scale and for reference only

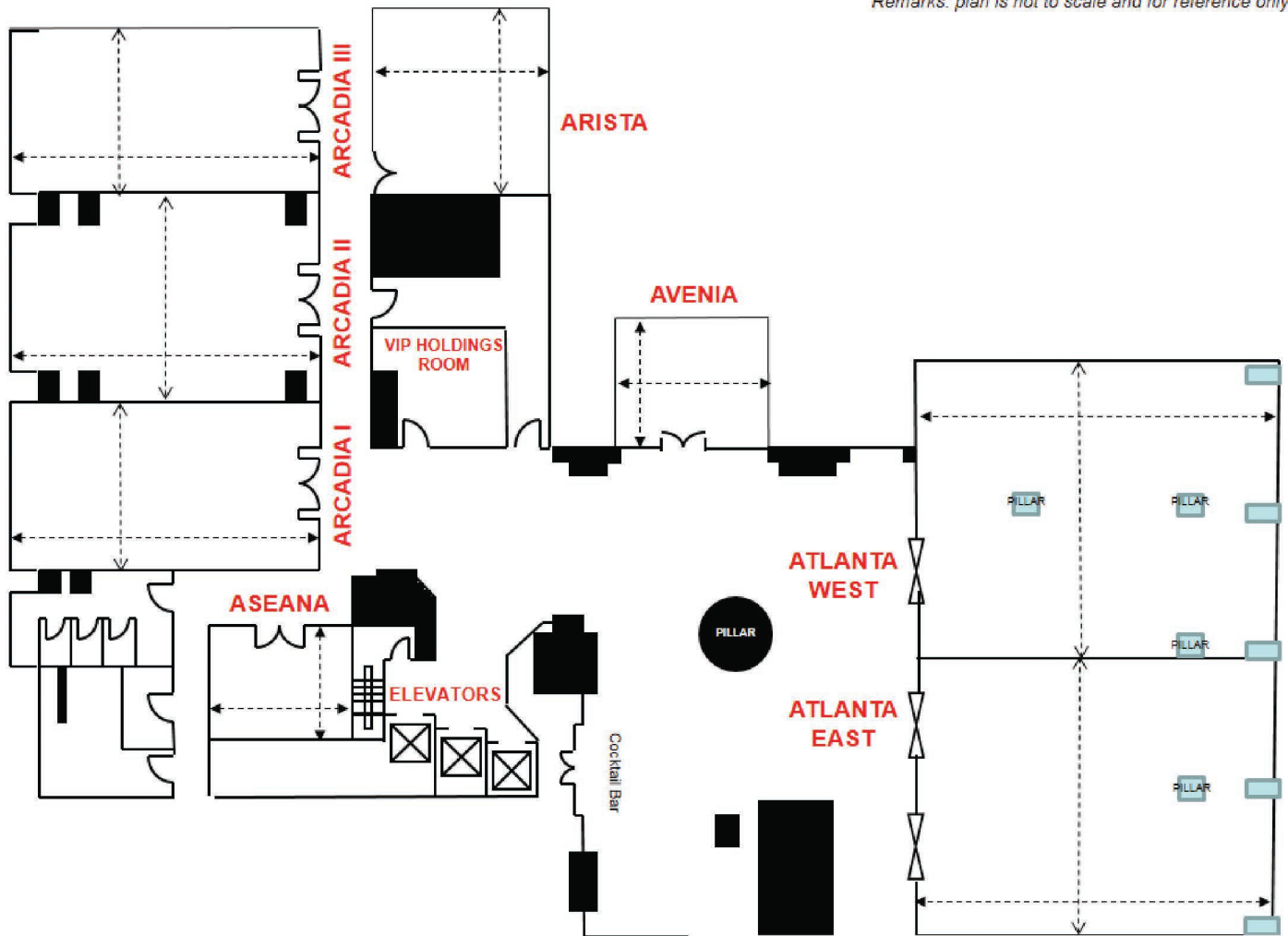

THE LATITUDE, LEVEL 1

Remarks: plan is not to scale and for reference only

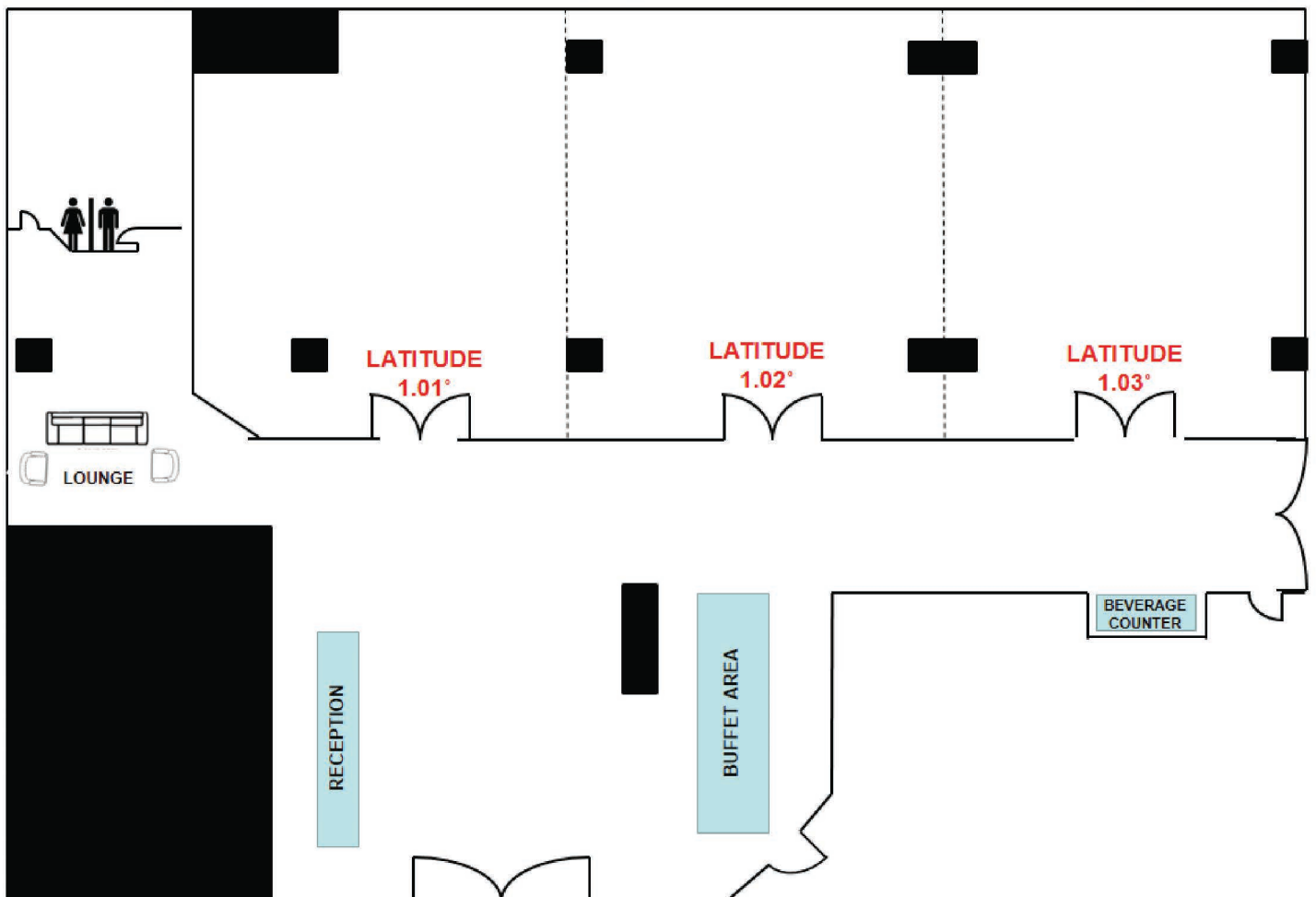

CONFERENCE SCHEDULE

Time	Atlanta Ballroom	The Latitude 1.01 Hall	The Latitude 1.02 Hall	The Latitude 1.03 Hall	The Arcadia 1 Hall
09.00 - 09.45	Inauguration				
09.45 - 10.30		Conference Photograph and Morning Refreshments			
10.30-11.15	Keynote Speech				
11.20-12.20	Publication workshop				
12.20-13.20		Lunch			
13.20 - 15.08	TECHNICAL SESSION 1: Occupational and Environmental Health 1 (A)	TECHNICAL SESSION 02: Child Health 1 (B)	TECHNICAL SESSION 03: Health Care Systems 1 (C)	TECHNICAL SESSION 04: Infectious Diseases 1 (D)	TECHNICAL SESSION 05: Preventive Health 1 (E)
15.08 - 15.25		Evening Refreshments			
15.25 - 17.13	TECHNICAL SESSION 06: Occupational and Environmental Health 2 (A)	TECHNICAL SESSION 07: Child Health 2 (B)	TECHNICAL SESSION 08: Health Care Systems 2 (C)	TECHNICAL SESSION 09: Infectious Diseases 2 (D)	TECHNICAL SESSION 10: Student's Session (Undergraduates) 01 (S)
17.20 - 18.20	Round table discussion				
19.00 Onwards	Networking dinner with cultural show				

Day 1 - 27th
Thursday 2017

Time	Atlanta Ballroom	The Latitude 1.01 Hall	The Latitude 1.02 Hall	The Latitude 1.03 Hall	
08.30 onwards					
09.00 - 10.30	TECHNICAL SESSION 11: Maternal Health 1 (F)	TECHNICAL SESSION 12: Health Care Systems 3 (C)	POSTER SESSION TECHNICAL SESSION 13: Smoking, Alcohol and Health (G)	TECHNICAL SESSION 14: Nutrition 1 (H)	
10.30 - 10.45			Morning Refreshments		
10.45 - 11.30	Keynote speech				
11.35 - 13.05	TECHNICAL SESSION 15: Maternal Health 2 (F)	TECHNICAL SESSION 16: School and Student Health (K)	TECHNICAL SESSION 17: Occupational and Environmental Health 3 (A)	TECHNICAL SESSION 18: Preventive Health 2 (E)	
13.10 - 14.00		Lunch			
14.10 - 16.20	TECHNICAL SESSION 19: Health Care Systems 4 (C)	TECHNICAL SESSION 20: Mental Health 1 (M)	TECHNICAL SESSION 21: Primary Health care 1 (J)	TECHNICAL SESSION 22: Health Promotion, Education and Hospital Management (N)	Poster Session 1 & 2 (14.30 - 15.40)
16.20 - 16.35		Evening refreshments			
16.35 -17.50	TECHNICAL SESSION 23: Adolescent & Young Adults Health (T)	TECHNICAL SESSION 24: Metabolic Syndrome (R)	TECHNICAL SESSION 25: Mental Health 2 (M)	TECHNICAL SESSION 26: Oral Health and Pharmacy (Q)	Poster Session 2 & 4 (16.45 - 17.50)
18.00 - 19.00	Student Gathering				

Day 2 - 28th Friday
2017

Day 3 - 29th Saturday 2017	Time	Atlanta Ballroom	The Latitude 1.01 Hall	The Latitude 1.02 Hall	The Latitude 1.03 Hall	The Arcadia 1 Hall
	9.00 - 10.30	TECHNICAL SESSION 27: Preventive Health 3 (E)	TECHNICAL SESSION 28: Nutrition 2 (H)	TECHNICAL SESSION 29: Mental Health 3 (M)	TECHNICAL SESSION 30: Clinical Medicine 1 (Y)	TECHNICAL SESSION 31: Student's Session (Undergraduates) (S)
	10.30 - 10.50		Morning Refreshment			
	10.50 -12.40	TECHNICAL SESSION 32: Primary Health Care 2 (J)	TECHNICAL SESSION 33: Sociology and Health (V)	TECHNICAL SESSION 34: Young Adults and Elderly (Z)	TECHNICAL SESSION 35: Clinical Medicine 2 (Y)	TECHNICAL SESSION 36: Preventive Health 4 (E)
	12.40 - 13.10	Conference Chair workshop				
	13.10 - 13.30	Conference Concluding and Awarding ceremony				
	13.30 onwards		Networking Lunch			

DAY 01

Thursday, 27th July, 2017

Coming up in line as Special Features: -

- Publication Workshop
- Round Table Discussion
- Cultural Show and Networking Dinner

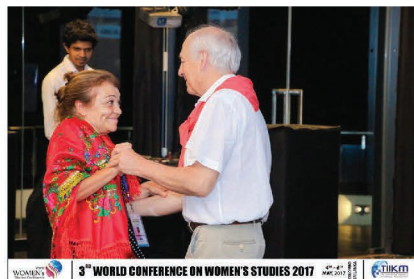

Reach Us Online

Like us on



www.facebook.com/TiikMconferences/



Conference Photos

tag, share, comment



Conference Updates

Publication Info



Inquiries



Share Ideas with Colleagues



View Conference Videos



Follow us

https://twitter.com/Tiikm_SriLanka



Subscribe

www.youtube.com/user/tiikmSriLanka



Follow us

<https://plus.google.com/+Tiikm>



Follow us

www.linkedin.com/company/the-international-institute-of-knowledge-management-tiikm-



"Stay Connected... Be Benefited..."



Technical Program

Inauguration Session

Thursday, 27th July 2017 | 09.00 to 09.45 (Atlanta Ballroom)

07.00 – 08.45	Conference Registration
09.00 – 09.10	Welcome address by the Program Chair Mr. Isanka P. Gamage (<i>Co-Founder & Managing Director - The International Institute of Knowledge Management (TIKM), Sri Lanka</i>)
09.10 – 09.20	Chair Speech by Prof. Dr. Hematram Yadav (<i>Department of Community Medicine, MAHSA University, Malaysia</i>)
09.20 – 09.30	Chair Speech by Prof. Dr. Rusli Bin Nordin (<i>Professor of Public Health Medicine (Occupational Health) , Clinical School Johor Bahru Jeffrey Cheah School of Medicine and Health Sciences, Monash University Malaysia</i>)
09.30 – 09.40	Speech by the Chief Guest Datuk Dr. Noor Hisham Abdullah (<i>Director-General of Health Malaysia & Senior Consultant in Breast & Endocrine Surgery</i>)
09.40 – 09.45	Web Launch
09.45 – 10.30	Conference Photograph & Morning Refreshments

KEYNOTE SPEECH

Thursday, 27th July 2017 | 10.30 to 11.15 (Atlanta Ballroom)

10.30 – 11.15	Keynote Speech on “Innovation and Collaboration in Public Health” by Datuk Dr. Noor Hisham Abdullah (<i>Director-General of Health Malaysia & Senior Consultant in Breast & Endocrine Surgery, Malaysia</i>)
---------------	---

PUBLICATION WORKSHOP

Thursday, 27th July 2017 | 11.20 to 12.20 (Atlanta Ballroom)

11.20 – 12.20	Prof. Wah-Yun Low , PhD, AFBPsS, FBSCH, CPsychol (<i>Head, Research Management Centre, Faculty of Medicine, University of Malaya, Malaysia</i>)
12.20 – 13.20	Networking Lunch

TECHNICAL SESSION 1: Occupational and Environmental Health 1 (A)

Thursday, 27th July 2017 | 13.20 to 15.08 (Atlanta Ballroom)

Chaired by Dr. Mohd Hafiz Jaafar (*Universiti Sains Islam Malaysia, Malaysia*)

13.20 – 13.38	A1	Work-Related Illnesses of Rice Farmers in Mae Yao Sub-District, Meuang District, Chiang Rai Province Lerdponmatulee Nichapat (<i>Chiang Rai Rajabhat University, Thailand</i>)
13.38 – 13.56	A2	Patterns of Seat Belt Use among Front Seat Occupants; Khartoum State, Sudan from August to November 2015 Islam Afendi (<i>Sudan Medical Specialization Board, Sudan</i>)
13.56 – 14.14	A3	Identifying Challenges in Tuberculosis Treatment Adherence and Cross-Border Referral among Local and Migrant Workers in the Mining Sector in Southern Africa M. Muzigaba (<i>Durban University of Technology South Africa, South Africa</i>)
14.14 – 14.32	A4	Determining Safe Duration of Toluene Exposure toward Footwear Workers Tualeka Ar, Jannah F, Raharjo Nk, Abdillah Oz, Fahmi As (<i>Airlangga University, Indonesia</i>)
14.32 – 14.50	A5	The Related Factors with Cholinesterase Level of Blood Palm Farmers as Result of Pesticides Exposure in Petajen Village Herdianti (<i>Public Health Program of Institute of Health Science Harapan Ibu Jambi, Indonesia</i>)
14.50 – 15.08	A6	Environmental and Occupational Health Impact of Buaxite Mining in Malaysia: A Review Amqureshi, Rbnordin, Klyiqian, Hlhua, Tkhooi, Tying, Spling, Tponnudurai (<i>Monash University, Malaysia</i>)
15.08 – 15.25	Evening Refreshments	

TECHNICAL SESSION 02: Child Health 1 (B)

Thursday, 27th July 2017 | 13.20 to 15.08 (The Latitude 1.01 Hall)

Chaired by Dr. Prabal Bhargava (*Taylor's University, Malaysia*)

13.20 – 13.38	B1	Usage of Child-Health-Developmental-Records for Assessment of Developmental Milestones among Mothers in Colombo District Fazla Fayaz (<i>University of Colombo, Sri Lanka</i>)
13.38 – 13.56	B2	Association between Blood Lead Levels and Basophilic Stippling Erythrocytes in Children Nissa Noor Annashr ¹ , I Made Djaja ² , Kusharisupeni ³ (<i>Institute of Health Science, Indonesia¹, Universitas Indonesia, Indonesia^{2,3}</i>)
13.56 – 14.14	B3	Infant and Young Child Feeding Carballo M ^{1,2} , Khatoon N ¹ , Maclean E ² , Al Hamad N ³ , Al Wotayan R ³ , Mohammad A ¹ , Abraham S ¹ (<i>¹Dasman Diabetes Institute, Kuwait, ²International Centre for Migration Health and Development, Geneva, ³Ministry of Health, Kuwait</i>)
14.14 – 14.32	B4	Compliance to Essential Intrapartum and Newborn Care in Government Facilities, Bukidnon, Philippines Domagsang, P. V, Camatura, D. G, Bariñan, E. N, & Majestrado, M. J. J (<i>Central Mindanao University, Philippines</i>)
14.32 – 14.50	B5	The Relationship between the Full Range of Birth Weight and Childhood Weight Status: By Gestational Age L Cai ¹ , Phd. J Tao ² , L Lin ¹ , J Ma ³ , Phd. J Jing ¹ , Phd. Y Chen ¹ , Phd. (<i>Sun Yat-Sen University^{1,2}, Peking University, China³</i>)
14.50 – 15.08	B6	Parents' Perception of Childhood Obesity for Development of Obesity Prevention Program: A Review Darimiyya Hidayati (<i>Airlangga University, Indonesia</i>)
15.08 – 15.25	Evening Refreshments	

TECHNICAL SESSION 03: Health Care Systems 1 (C)

Thursday, 27th July 2017 | 13.20 to 15.08 (The Latitude 1.02 Hall)

Chaired by Dr. Mohammad Jaweed (*Taylor's University, Malaysia*)

13.20 – 13.38	C1	The Effectiveness of Community Health Worker Training Programs for Cardiovascular Disease Management in Low and Middle Income Countries – A Systematic Review M. Abdel-All, B. Putica, D. Praveen, S. Abimbola and R. Joshi (<i>University of Sydney, Australia</i>)
13.38 – 13.56	C2	Overcoming the Challenges of Facility Based Delivery in the Municipality of Kapangan Mesaël M. Mating, L. M. A Laruan, M. E Fermin (<i>Local Government of the Municipality of Kapangan, Philippines</i>)
13.56 – 14.14	C3	Feasibility of Compulsory State Health Insurance Schemes Using a Community Approach F.N Ilika, A. Alawode, S. Akande, E. Baruwa (<i>Health Finance and Governance Project, Nigeria</i>)
14.14 – 14.32	C4	Participation of Farmer Household Non-Contribution Assistance Recipient in the National Health Insurance Program in Indonesia Abu Khoiri (<i>Airlangga University, Indonesia</i>)
14.32 – 14.50	C5	Stress among Residents in a Tertiary Care Center, Riyadh, Saudi Arabia: Prevalence and Associated Risk Factors Ahmed A. Bahnassy (<i>King Fahad Medical City, Saudi Arabia</i>)
14.50 – 15.08	C6	The Effect of Being in Paid Work in Later Life on Mortality and Morbidity: Evidence from Japan Shohei Okamoto (<i>Keio University, Japan</i>)
15.08 – 15.25	Evening Refreshments	

TECHNICAL SESSION 04: Infectious Diseases 1 (D)

Thursday, 27th July 2017 | 13.20 to 15.02 (The Latitude 1.03 Hall)

Chaired by Prof (Dr) Forhad Akhtar Zaman (*Sikkim Manipal Institute of Medical Sciences, India*)

13.20 – 13.50	Plenary Speech on “Global Burden of Tuberculosis & Drug Resistant TB” by Prof. Dr. Forhad Akhtar Zaman (<i>Sikkim Manipal Institute of Medical Sciences, India</i>)	
13.50 – 14.08	D1	Prevalence of Campylobacter in less than 10 year children in Southern Punjab, Pakistan Qurratul Ann Alvi, Ahsan Sattar Sheikh, Aleem Ahmad Khan (<i>Bhauddin Zikariya University, Multan, Pakistan</i>)
14.08 – 14.26	D2	Towards an Acceptable HIV Prevention Technology Post 2016: A Qualitative Study of Microbicides among University Students in Kwazulu- Natal, South Africa Phiwe Babalo Nota (<i>University of Kwazulu-Natal, South Africa</i>)
14.26 – 14.44	D3	Knowledge, Attitude and Practice towards Dengue in Urban Area of Indonesia ¹ Sulistyawati Sulistyawati, ¹ Joacim Rocklov, ¹ Asa Holmner, ² Fardhiasi Dwi Astuti, ³ Sitti Rahmah Umniati (SR), ³ Tri Baskoro Tunggal Satoto, ³ Lutfan Lazuarti (<i>¹Umea University, Sweden; ²Ahmad Dahlan University, Indonesia, ³Gadjah Mada University, Indonesia</i>)
14.44 – 15.02	D4	Partnership of Cadres Tb - HIV Care Aisyiyah to Increase Case Finding Rate Tuberculosis in Jeneponto, Indonesia Syahridha (<i>Airlangga University, Indonesia</i>)
15.08 – 15.25	Evening Refreshments	

TECHNICAL SESSION 05: Preventive Health 1 (E)

Thursday, 27th July 2017 | 13.20 to 14.50 (The Arcadia 1 Hall)

Chaired by Assoc. Prof Nurjahan Mohd Ibrahim (*Taylor's University, Malaysia*)

13.20 – 13.38	E1	Cervical Cancer and Pap Smear Screening: Knowledge, Attitude and Practice among Working Women in Northern State of Malaysia Rodziah Romli ^{1,2} , Sa'adiah Shahabudin ¹ , Norehan Mokhtar ¹ , Norkhafizah Saddki ¹ (<i>Universiti Sains Malaysia, Malaysia¹, Kolej Pembantu Perubatan Alor Setar, Malaysia²</i>)
13.38 – 13.56	E2	Determinants of Physical Activity in a College Students' Association of South Sumatera Indonesia Atidira Dwi Hanani (<i>University of Indonesia, Indonesia</i>)
13.56 – 14.14	E3	The Health Impacts of Reduced Residential Solid Fuel Burning on the South African Highveld Lindeque, L.F., Burger, R.P. and Piketh, S.J. (<i>North West University, South Africa</i>)
14.14 – 14.32	E4	Obesity Prevention through <i>Cangkrukan</i>, Eating and Physical Habit among Students of Senior High School in Surabaya, Indonesia 2017 Suharmanto, Windu Purnomo (<i>Airlangga University, Indonesia</i>)
14.32 – 14.50	E5	Survey of Indonesian Public Awareness Index on Drug and Food Tiur Dina Waty, Sri Murhandini (<i>Research Center for Drug and Food, National Agency of Drug and Food Control of the Republic of Indonesia</i>)
15.08 – 15.25	Evening Refreshments	

TECHNICAL SESSION 06: Occupational and Environmental Health 2 (A)

Thursday, 27th July 2017 | 15.25 to 16.55 (Atlanta Ballroom)

Chaired by Prof (Dr) Vijay Kumar Mehta (*Sikkim Manipal University, India*)

15.25 – 15.43	A7	Ergonomic Work Station Improvement for Wood - Cutting Process in Furniture Factory Theppitak C., Chaiyadit P., Thaitanee K., Bun-Um S., Suaikhornburee U. (<i>Suranaree University of Technology, Thailand</i>)
15.43 – 16.01	A8	Work Environment Assessment of a Community Rice Mill: A Pilot Study in Thailand P. Boonruksa and Y. Limmongkon (<i>Suranaree University of Technology, Thailand</i>)
16.01 – 16.19	A9	Bioaerosol Measurement Using Different Equipment: A Preliminary Study in Community Rice Mill Y. Limmongkon, P. Boonruksa, K. Phengarree (<i>Suranaree University of Technology, Thailand</i>)
16.19 – 16.37	A10	Ergonomic Risk Factors and Musculoskeletal Disorders Symptoms among Natural Stone Carving Craftsmen Hendra Djamalus, Anggit Paramitha (<i>Universitas Indonesia, Indonesia</i>)
16.37 – 16.55	A11	Automated Occupational Carcinogen Exposure Assessment System: Application of an Innovative Tool for Malaysian Manufacturing Employees Begum J, Isahak M, Bhoo-Pathy N., L. Fritschi, Darus A (<i>University of Malaya, Malaysia</i>)

TECHNICAL SESSION 07: Child Health 2 (B)

Thursday, 27th July 2017 | 15.25 to 17.13 (The Latitude 1.01 Hall)

Chaired by Dr. Rekha Probhu (*Taylor's University, Malaysia*)

15.25 – 15.43	B7	Impact of Physical Abuse on Growth and Development of Children Aged 3-5 Years in Rural Vidarbha Tendolkar V. D, Kulkarni B. D. (<i>Datta Meghe Institute of Medical Sciences (Deemed University), India</i>)
15.43 – 16.01	B8	Comparison of Parents and Child Perceptions :- Related to Parenting Efficacy and Childhood Obesity, Ludhiana, Punjab Premata Prakash (<i>College of Nursing, CMC and Hospital, India</i>)
16.01 – 16.19	B9	Readiness of the Growth and Development Problem of Children Aged Under 5 Years Intervention Program in Bangkalan Qurnia Andayani (<i>Airlangga University, Indonesia</i>)
16.19 – 16.37	B10	Best Practices to Decrease Acute Respiratory infections in under Five Years Children in Surabaya: An Environmental Health Perspectives Corie I Prasasti, Lilis Sulistyorini, Arief Hargono (<i>Airlangga University, Indonesia</i>)
16.37 – 16.55	B11	Effect of Maternal Vitamin D Levels on Anthropometric Measures in Infants K. Anusha, U.P.K Hettiaratchi, G.S.H Liyanage (<i>University of Sri Jayewardenepura, Sri Lanka</i>)
16.55 – 17.13	B12	Health Profile and Status of Children in a Selected Foundling Home: Basis for a Proposed Health Monitoring Program Liwanag, MC, Cabanban, ID (<i>Centro Escolar University, Philippines</i>)

TECHNICAL SESSION 08: Health Care Systems 2 (C)

Thursday, 27th July 2017 | 15.25 to 16.55 (The Latitude 1.02 Hall)

Chaired by Assoc. Prof Abdul Kareem Meera Mohaideen (*Taylor's University, Malaysia*)

15.25 – 15.43	C7	Integrating Collaborative Data Entry Technology in Community Health Assessment Guinitaran, KJG, Camatura, DGC, Domagsang, PVD (<i>Central Mindanao University, Philippines</i>)
15.43 – 16.01	C8	Social Environment Factors that Associated with Contraceptives Selection in Gading Public Health Center in Tambaksari Surabaya Indonesia Asti Dewi Rahayu Fitrianiingsih (<i>University of Indonesia, Indonesia</i>)
16.01 – 16.19	C9	Integrated Medical Curriculum in Malaysia - Experience, Outcome and Limitations Darnal Hari Kumar (<i>Mahsa University, Malaysia</i>)
16.19 – 16.37	C10	Evaluating the Usability of the Uganda Clearinghouse for Health Policy and System Mutatina B (<i>Makerere University, Uganda</i>)
16.37 – 16.55	C11	Intelligent Digital on boarding Mishra Namrata (<i>Altimetrik India Pvt. Ltd, India</i>)

TECHNICAL SESSION 09: Infectious Diseases 2 (D)

Thursday, 27th July 2017 | 15.25 to 16.19 (The Latitude 1.03 Hall)

Chaired by Prof (Dr) Forhad Akhtar Zaman (*Sikkim Manipal Institute of Medical Sciences, India*)

15.25 – 15.43	D5	Cholera Outbreak in Samana, Punjab, India, 2016 - A Public Health Threat in 21st Century Kumar Satish (<i>Integrated Disease Surveillance Programme (IDSP), India</i>)
15.43 – 16.01	D6	Disease Burden of <i>Clostridium Difficile</i> Infection in Adults from 2006 through 2014: Results from a Territory - Wide Population Study in Hong Kong J Ho, RZW Dai, TNY Kwong, XS Wang, SC Ng, WKK Wu, SH Wong (<i>The Chinese University of Hong Kong, Hong Kong</i>)
16.01 – 16.19	D7	Improving HIV/Aids Surveillance System: From Manual Way to Web - Based Information System in Gunungkidul, Indonesia, 2016 Gaby G. Langi ¹ , R. A. Ahmad ¹ , S. Raharto ² (¹ <i>Universitas Gadjah Mada, Indonesia</i> , ² <i>Gunungkidul District Health office, Indonesia</i>)

TECHNICAL SESSION 10: Students' Session 01 (Undergraduates) (S)

Thursday, 27th July 2017 | 15.25 to 17.13 (The Arcadia 1 Hall)

Chaired by Prof. Dr. Rusli Bin Nordin (*Monash University, Malaysia*)

15.25 – 15.43	S1	HIV Stigma among Medical Students in East Java, Indonesia Alkaff FF, Syamlan AT, Salamah S, Nugraha RA, Jonatan M, Octora TN, Luke K , Sulistyowati (<i>Airlangga University, Indonesia</i>)
15.43 – 16.01	S2	Rehabilitation Program for Smokers among Student: Smart Solution to Decrease the Number of Active Smoker in Smkn 2 Bandar Lampung Muhammad Dimas Pangestu, Geta Okta Prayogi, Nopri Yanda Harajab, Muhammad Fakhri Abdurrahman , Nisrina Aulia Amirah (<i>University of Lampung, Indonesia</i>)
16.01 – 16.19	S3	Correlation between Parenting Pattern and Mpasi - Giving Pattern to Nutritional Status of Infants Aged 6-12 Months in Mekargalih Village Melinda Sagala (<i>Universitas Indonesia, Indonesia</i>)
16.19 – 16.37	S4	The Impact of National Health Insurance Knowledge on Enrollment and Health Care Utilization in North Jakarta Tiffany Fransisca, Nico, Bryany Titi Santi (<i>Atma Jaya Catholic University of Indonesia, Indonesia</i>)
16.37 – 16.55	S5	The Difference in Universal Precaution Practice among Medical Students in HIV and Non-HIV Ward in East Java, Indonesia: A Comparative Study Alkaff FF, Syamlan AT, Salamah S, Nugraha RA, Jonatan M, Octora TN, Luke K , Sulistyowati (<i>Airlangga University, Indonesia</i>)
16.55 – 17.13	S6	The Association of Ergonomic Mismatch and Self- Reported Pain among Students of a College in a Public University in the Philippines Torres, C. H (<i>University of The Philippines Manila, Philippines</i>)

Thursday, 27th July 2017 | 17.15 to 18.15 (Atlanta Ballroom)

17.15 – 18.15	Round Table Discussion
19.00 Onwards	Networking Dinner with Cultural Show

Round Table Discussion

The International Conference on Public Health (ICOPH 2017) will host a round table discussion for the senior researchers aiming to create a unified platform for participants to discuss on SDG' s and debate on some of the global issues that would be in the form of discussion points.

The objective of this feature in this year's Conference is to enhance the gathering with wisdom and useful knowledge enabling the emergence of possible solutions to issues faced globally in relation to the subject matter.

Date : - 27th July 2017 (Day I)

Time : - 05.00 p.m. - 06.00 p.m.

Agenda

1. Introduction by Prof. Rusli bin Nordin (5 mins)
2. Introduction by Prof. Hematram Yadav (5 mins)
3. Discussion SDG' s on below topics (40 mins)



The SDGs are unique in that they cover issues that affect us all. They reaffirm our international commitment to end poverty, permanently, everywhere. They are ambitious in making sure no one is left behind. More importantly, they involve us all to build a more sustainable, safer, more prosperous planet for all humanity.

- What can we do to ensure that the SDGs are on track in all member countries?
- What measurable indicators of success can we develop to track the progress of the SDGs in member countries?
- How do we collaborate to work towards the realization of the SDGs in member countries?
- What can we suggest to governments and UNDP to support our effort towards the realization of the SDGs?
- Can we come up with a “ICOPH2017 Declaration” supporting our work towards the realization of the SDGs?

4. Conclusion session - 10 mins



Networking Dinner & Cultural Show

The International Conference on Public Health (ICOPH 2017) will host a Networking dinner and a Cultural Show with the prime objective of making the conference experience a once in a life time moment to the valued participants.

Date: 27th July, 2017

Time: 7.00 pm onwards

Attire: National Costumes

The agenda

- 7.00 pm : The commencement of the Dinner with the Cultural Show
- 7.10 pm : The Welcome by the Organizing Committee
- 7.20 pm : Surprise Fun Activity
- 7.40 pm : Commencement of the Dinner
- 8.30 pm : Individual / Group Performances by the participants
- 9.00 pm : Commencement of the DJ night
- 10.00 pm : Closure of the Program

NOTE: The networking dinner is FREE of charge to all conference participants, and if any other outside party (may be a family member / friend of any participant) wishes to attend to this, he/she may also do by paying an additional amount if needed.

The amusement awaits!!



DAY 02

Friday, 28th July, 2017

Coming up in line as Special Features: -

-Poster Session

-Students' Gathering





INTERNATIONAL CONFERENCE ON DRUG DISCOVERY & DEVELOPMENT

"Medicines for the 21st century"

12th -13th September 2017
Colombo, Sri Lanka

CONFERENCE TRACKS

New synthetic and screening technologies
for discovering novel active ingredients.
Harnessing natural products chemistry for
new medicines.

Manufacturing and processing technologies
for dosage form development.

Advanced pharmaceutical analysis techniques.

Personalized and age-appropriate medicines:
tailoring therapy to the individual.

The changing role of the pharmacist.

REGISTER NOW

www.drugdiscoveryconference.co



INTERNATIONAL CONFERENCE ON FOOD, QUALITY, SAFETY AND SECURITY

*"Better Life through Sustainable Production of
Quality and Safe Foods"*

24th -25th October 2017
Colombo, Sri Lanka

CONFERENCE TRACKS

Food Insecurity; Causes, Consequences
and Remedies

Post-Harvest Losses and Remedies

Reducing Food Loss and Waste

Food Quality and Safety

Biodiversity and Food Production

Food Production System

ICT Tools in Networking Stakeholders in
Food Sector

Under-Nutrition, Obesity and Micronutrient
Deficiencies and Food Security Challenges

REGISTER NOW

www.foodsecurityconference.co

TECHNICAL SESSION 11: Maternal Health 1 (F)

Friday, 28th July 2017 | 09.00 to 10.30 (Atlanta Ballroom)

Chaired by Prof (Dr) Vijay Kumar Mehta (*Sikkim Manipal University, India*)

09.00 – 09.18	F1	Maternal and Child Health of Ethnic Group in Northern Thailand Watcharapong Ruankham (<i>Chiang Rai Rajabhat University, Thailand</i>)
09.18 – 09.36	F2	Perceive of Vulnerability among High Risk Pregnant Mother Who Refuse Referred to the Health Facility in Paiton, Probolinggo, Indonesia Mirrah Samiyah, I Wayan Gede Artawan Eka P, Ilyas Ibrahim, Qurnia Andayani (<i>Airlangga University, Indonesia</i>)
09.36 – 09.54	F3	Client Satisfaction with Maternal and Child Health Care Services at a Public Specialist Hospital in a Nigerian Province Babalola Tesleem K. , Okafor Ifeoma P (<i>University of Lagos, Nigeria</i>)
09.54 – 10.12	F4	Barriers Faced by Health Providers and Women in Post-Abortion Contraception Care: A Qualitative Study Razia Naveed, Saima Hamid (<i>Quaid-I-Azam University, Pakistan</i>)
10.12 – 10.30	F5	Can Community Midwives Effectively Integrate Family Planning Services in the Community through Social Franchise Network? An Observational Study in Peri-Urban Karachi, Pakistan Haris Ahmed, Hina Najmi and Lutaf Ali (<i>Sukh Initiative, Aman Health Care Services Aman Foundation, Pakistan</i>)
10.30 – 10.45	Morning Refreshments	

TECHNICAL SESSION 12: Health Care Systems 3 (C)

Friday, 28th July 2017 | 09.00 to 10.30 (The Latitude 1.01 Hall)

Chaired by Dr. Rekha Probhu (*Taylor's University, Malaysia*)

09.00 – 09.18	C12	Migrant Health – A Study on Morbidity Status, Addictions and Health Seeking Behaviour of Migrant Workers V.T. Krishnadas Menon, Mohammed Ibrahim, Remya Ramachandran, Babita susan Kuruvilla (<i>Amala Medical College, India</i>)
09.18 – 09.36	C13	Evaluation of “Simple Web” Development based on the Delone and Mclean Model Atik C.H, Arina M.E, Hari B. (<i>Universitas Airlangga, Indonesia</i>)
09.36 – 09.54	C14	Big Data Analytics and Cloud Computing: A Game Changer in Managing Public Health Data Rajesh Kumar Sinha (<i>Manipal University, India</i>)
09.54 – 10.12	C15	Scaled Up Health Workforce and Intensified Mobile Health Camps in Hard-to-Reach Pockets: Contributing to Reduced Severe Malaria in Bangladesh Naher, M. Moktadir Kabir, Md Abdul Karim (<i>BRAC Center, Bangladesh</i>)
10.12 – 10.30	C16	Digitizing Service Delivery Process of Government Health Workers in Bangladesh: A Journey towards Comprehensive eMIS Chowdhury SK, Kabir MH, George J, Arifeen SE (<i>Maternal and Child Health Division, ICDDR,B, Bangladesh</i>)
10.30 – 10.45	Morning Refreshments	

TECHNICAL SESSION 13: Smoking, Alcohol and Health (G)Friday, 28th July 2017 | 09.00 to 10.12 (The Latitude 1.02 Hall)Chaired by Dr Gul Baloch (*Taylor's University, Malaysia*)

09.00 – 09.18	G1	Prevalence, Knowledge, Attitude and Practice towards Electronic Cigarette among Undergraduate Students in USIM Mohd Hafiz Jaafar, Nadeeya 'Ayn Umaisara Mohd Nor, Mohamed Fakhri Abu Baharin, Shalinawati Ramli, Tengku Amatullah Madeehah Tengku Mohd, Dzulkahiri Mohd Rani, Zairina Abdul Rahman, Mohd Noorah Mohammed Salleh (<i>Universiti Sains Islam Malaysia, Malaysia</i>)
09.18 – 09.36	G2	The Economic Impact of Smoking Cont*/rol: An Approach of Dynamic General Equilibrium Yoko Iwaki ¹ , Michael C. Huang ² (¹ <i>National Center For Global Health and Medicine, Japan</i> ¹ , ² <i>National Graduate Institute For Policy Studies, Japan</i> ²)
09.36 – 09.54	G3	Prevention and Control of Malaria in Perspectives People of Naulu Tribe Nur Baharia Marasabessy (<i>Airlangga University, Indonesia</i>)
09.54 – 10.12	G4	Theory of Planned Behaviour (TPB) for Smoking Cessation: Psychometric Properties of The Malay Version ¹ Ruslan NH, ² Yasin SM, ² Isa MR, ² Mohd Nasir, ³ Taib KM, ⁴ Ahing T, ⁵ Sanudin ND, ² Rajikin MH (^{1,2,3,4} <i>Universiti Teknologi Mara, Malaysia</i> , ⁵ <i>Universiti Pendidikan Sultan Idris, Malaysia</i>)
10.30 – 10.45	Morning Refreshments	

TECHNICAL SESSION 14: Nutrition 1 (H)Friday, 28th July 2017 | 09.00 to 10.30 (The Latitude 1.03 Hall)Chaired by Prof. Dr. Hematram Yadav (*MAHSA University, Malaysia*)

09.00 – 09.18	H1	Knowledge and Risk Factors Associated with Sodium Intake of Chinese Haw Tribes at Chiang Rai Province, Northern of Thailand Phatcharin Winyangkul (<i>Chaing Mai University, Thailand</i>)
09.18 – 09.36	H2	Validity of Household Dietary Diversity Score as a Measure of Food Insecurity among Households in Lucena City, Quezon Arias FP (<i>University of The Philippines, Philippines</i>)
09.36 – 09.54	H3	Dietary Supplement Use and Its Effect on Nutrient Intakes and Growth among Toddlers in China Ai Zhao, Hao Li, Wei Zheng, Yumei Zhang (<i>Peking University Health Science Center, China</i>)
09.54 – 10.12	H4	Nutritional Status, Dietary Habits and Physical Activity Preferences of Malaysian Medical Students Hasamnis A. A (<i>Taylor's University, Malaysia</i>)
10.12 – 10.30	H5	Dietary Macronutrient Intake among Sri Lankan Rural Female Type 2 Diabetics and Non-Diabetics and Effect towards the Glycemic Control R.G.L. Rathnayake, U.P.K. Hettartchi, P.P.R. Perera (<i>University of Sri Jayewardenepura, Sri Lanka</i>)
10.30 – 10.45	Morning Refreshments	

KEYNOTE SPEECHFriday, 28th July 2017 | 10.45 to 11.30 (Atlanta Ballroom)

10.45 – 11.30	Keynote Speech on "The Health Burden Associated with Children's Exposures to Environmental Chemicals" by Prof. David C. Bellinger (<i>Professor in the Department of Environmental Health Harvard T. H. Chan School of Public Health, USA</i>)
---------------	---

TECHNICAL SESSION 15: Maternal Health 2 (F)

Friday, 28th July 2017 | 11.35 to 13.05 (Atlanta Ballroom)

Chaired by Prof. (Dr) Vijay Kumar Mehta (*Sikkim Manipal University, India*)

11.35 – 11.53	F6	Support of Family Health Day for Providing a Wide Range of Contraceptives, Including Long - Acting Reversible Contraceptives and Permanent Method in Peri-Urban Slums of Karachi Pakistan- A High Impact Practice in Family Planning Service Delivery Hina Najmi, Haris Ahmed, Lutaf Ali (<i>Sukh Initiative, Aman Health Care Services, Aman Foundation, Pakistan</i>)
11.53 – 12.11	F7	Who Made Them Who They are: Auxiliary Midwives in Providing Maternal and Child Health Care in Hard to Reach Areas of Myanmar Kyu Kyu Than ¹ ✉, Khine Nwe Tin ³ , Alison Morgan ² , James G Beeson ¹ ✉, Stanley Luchters ¹ ✉ (<i>Burnet Institute, Australia¹, University of Melbourne, Australia², Ministry of Health and Sports, Myanmar³, Monash University, Australia⁴, Ghent University, Belgium⁵</i>)
12.11 – 12.29	F8	Improving Processes and Outcome of Maternal Health Referrals at the District Level: The Role of an Enhanced Inter - Facility Referral Communication System Amoakoh-Coleman, M ¹ , Klipstein-Grobusch, K. ^{2,3} , Ansah, E.K ⁴ , Arhinful D.K. ¹ (<i>University of Ghana, Ghana¹, University Medical Center Utrecht, The Netherlands², University of the Witwatersrand, South Africa³, Ghana Health Service, Ghana⁴</i>)
12.29 – 12.47	F9	Improving Access Leads to Potential Savings with Increased Use of Long - Acting Reversible Contraception among Married Women with Reproductive Age Residing in Peri Urban - Underserved Areas of Karachi Umair Aslam, Haris Ahmed, Hina Najmi, Lutaf Ali (<i>Sukh Initiative, Aman Health Care Services Aman Foundation, Pakistan</i>)
12.47 – 13.05	F10	Identifying Determinants of Cervical Cancer Screening and Treatment Behaviours of Women in South - East Nigeria Negedu, O. V, Nwangwu, C. A., Taiwo, A. C., Harbor I. (<i>Marie Stopes International Organization Nigeria, Nigeria</i>)
13.10 – 14.00	Networking Lunch	

TECHNICAL SESSION 16: School and Student Health (K)

Friday, 28th July 2017 | 11.35 to 12.50 (The Latitude 1.01 Hall)

Chaired by Dr. Girish Prabhu (*Taylor's University, Malaysia*)

11.35 – 11.53	K1	Assessment of Knowledge about Autism among Undergraduate Medical Students Studying in Different Medical Colleges in Dhaka Bangladesh Zafrana Zahir (<i>Bangladesh Medical College Hospital, Bangladesh</i>)
11.53 – 12.11	K2	Student's Perception on Health and School Health: A Qualitative Study Muji Sulistyowati, Dan Muthmainnah (<i>Universitas Airlangga, Indonesia</i>)
12.11 – 12.29	K3	Water Supply and Sanitation Effects on School Survival: Evidence from the Philippines Ben Gascoyne (<i>University College London, United Kingdom</i>)
12.29 – 12.47	K4	Whole Grain Consumption and Its Determinants in Malaysian Medical Students Patil SS (<i>Taylor's University, Malaysia</i>)
13.10 – 14.00	Networking Lunch	

TECHNICAL SESSION 17: Occupational and Environmental Health 3 (A)

Friday, 28th July 2017 | 11.35 to 12.50 (The Latitude 1.02 Hall)

Chaired by Dr Gul Baloch (*Taylor's University, Malaysia*)

11.35 – 11.53	A12	Knowledge of Traffic Signs and the Ownership of a Driver's License to a Motorcycle User Lucia Yovita Hendrati (<i>Airlangga University, Indonesia</i>)
11.53 – 12.11	A13	Environmental Health in Mulyorejo District, Surabaya City, Indonesia Lilis Sulistyorini, M. Farid D. Lusno, Retno Adriani, Soenarnatalina M. (<i>Universitas Airlangga, Indonesia</i>)
12.11 – 12.29	A14	Association Historical of Pesticide Exposure to the Presence of Pesticide Metabolites in the Urine of Children in Brebes District Ilyas Ibrahim (<i>Airlangga University, Indonesia</i>)
12.29 – 12.47	A15	Relationship between Knowledge and Attitudes with Actions in Reducing Plastic Bags Usage among Fried Food Sellers in Manado, 2012 Sumbung H, Umboh J. M. L, Joseph W. B. S, Kawatu P. A. T (<i>University of Indonesia, Indonesia</i>)
13.10 – 14.00	Networking Lunch	

TECHNICAL SESSION 18: Preventive Health 2 (E)

Friday, 28th July 2017 | 11.35 to 13.07 (The Latitude 1.03 Hall)

Chaired by Assoc. Prof Nurjahan Mohd Ibrahim (*Taylor's University, Malaysia*)

11.35 – 11.55	Plenary Speech on “Why Does Gender Matter in Health Care of the Community” Prof. Kumudu Wijewardene (<i>Senior Professor of Community Medicine , Faculty of Medicine, University of Sri Jayewardenepura</i>)	
11.55 – 12.13	E6	The Effect of Different Exercise Programs on Bone Mineral Density and Physical Function in Women with Osteoporosis: a Randomized Controlled Trial Ardiana M ¹ , Nerimane A ¹ , Zana I ² , Vjollca SM ¹ , Eqrem G ¹ (<i>Physical Medicine and Rehabilitation Clinic¹, University Clinical Center of Kosovo², University of Kosovo, Kosovo²</i>)
12.13 – 12.31	E7	Is the Relationship between Age and Utilitarian Walking Influenced by the Neighbourhood Built Environment? Ghani F (<i>Australian Catholic University, Australia</i>)
12.31 – 12.49	E8	Quality of Life of Cerebral Palsy Patients and Their Caregivers: A Cross Sectional Study in a Rehabilitation Center Khartoum - Sudan (2014 – 2015) Fadwa M Saad ¹ , Suad M Ali ¹ , Mutaz Amin ² (<i>¹University of Khartoum, Sudan, ²University of Khartoum, Sudan</i>)
12.49 – 13.07	E9	Identifying the Knowledge, Attitudes and Needs of Disabled Individuals in Istanbul Province towards Disasters and Emergencies Zeynep Kirdi Harbawi (<i>Istanbul University, Turkey</i>)
13.10 – 14.00	Networking Lunch	

TECHNICAL SESSION 19: Health Care Systems 4 (C)

Friday, 28th July 2017 | 14.10 to 16.20 (Atlanta Ballroom)

Chaired by Dr. Binu Upreti (*Sikkim Manipal Institute of Medical Sciences, India*)

14.10 – 14.28	C17	Community Ownership and Participation in Deliverance of Health Care Services through Village Health, Sanitation and Nutrition Committees (VHSNCS) in Tribal and Non Tribal Areas in a District of Rajasthan, India Joshi S. M, Sharma. R (<i>R.N.T. Medical college, India</i>)
---------------	------------	---

14.28 – 14.46	C18	Evaluation CT Dose Index for Head on Multidetector Computed Tomography (MDCT) in Surabaya Wahyudi Ifani (<i>Airlangga University, Indonesia</i>)
14.46 – 15.04	C19	Socioeconomic Determinants of Maternal Anemia : A Disaggregated Level Analysis from Assam, India Dutta P, Sengupta B (<i>Indian Institute of Technology Guwahati, India</i>)
15.04 – 15.22	C20	Policy Options Evaluation on R & D Investment in Public Health: An Application of Spias-E Masahiro Kuroda, Kenta Ikeuchi, Yasushi Hara, Michael C. Huang (<i>Center For Research and Development Strategy (CRDS), Japan Science and Technology Agency, Japan¹, Research Institute of Economy, Trade and Industry, Japan², National Graduate Institute for Policy Studies, Japan³</i>)
15.22 – 15.40	C21	Policy and Regulatory Considerations for Electronic Health Information Exchange (HIE) in Malaysia Nuraidah Marzuki, Nilavu Karuppiah, Nurul Hannah Mohd Feizal, Fazilah Shaik Allaudin, Rohaizat Yon (<i>Ministry of Health, Malaysia</i>)
15.40 – 15.58	C22	Government's Expenditure in Eradication of Pulmonary Tb in the Era of Health Insurance in Indonesia (Case Study In Kediri City, East Java) Fauzan Adima, Rachmad Suhandu (<i>Airlangga University, Indonesia</i>)
15.58 – 16.20	C23	Use of Electronic Medical Records for Research in the Management of Type - 2 Diabetes Zainuddin NA ¹ , Abdul Hamid J ¹ , Md.Sharif S ¹ , Abdul Halim NH ¹ , Syed Ahmad Yunus SZ ² , Abu Bakar NS ¹ , Musa NSE ² , Abu Sapian R ² (<i>¹Institute for Health Systems Research, Malaysia, ²National Institute of Health Secretariat, Malaysia</i>)
16.20 – 16.35	Evening Refreshments	

TECHNICAL SESSION 20: Mental Health 1 (M)

Friday, 28th July 2017 | 14.10 to 16.20 (The Latitude 1.01 Hall)

Chaired by Prof (Dr) Vijay Kumar Mehta (*Sikkim Manipal University, India*)

14.10 – 14.28	M1	An Exploration of Job Stressors and Burnout among Nursing Assistants Yia-Wun Liang, Yu-Hsiu Lin (<i>National Taichung University of Science and Technology, Taiwan</i>)
14.28 – 14.46	M2	Internet Activities, Internet Addiction and Its Relationship with Depression: An Empirical Study Udayai K, Pathak V, Aggarwal N, Chauhan D (<i>International Institute of Health Management Research, India</i>)
14.46 – 15.04	M3	Mobile Phone Addiction and Incidence of Self Perceived Headache among 2nd and 3rd Year Undergraduates in University of Sri Jayewardenepura, Sri Lanka: Cross - Sectional Study Lasanthika T. L. C , Hettiaratchi U. P. K (<i>University of Sri Jayewardenepura, Sri Lanka</i>)
15.04 – 15.22	M4	Adjustment as a Predictor of Frustration, Stress and Suicidal Intend: A Cross Sectional Study among Health Professional Students Sarode R. D ¹ , Tendolkar V. D ² (<i>¹Datta Meghe Institute of Medical Sciences, India, ²Jawaharlal Nehru Medical College, India</i>)
15.22 – 15.40	M5	Participatory Exploration of Factors Influencing the Health of People with Intellectual Disabilities in an Urban District: A Photovoice Study Allweiss .T, Merlin Perowanowitsch (<i>Catholic University of Applied Sciences Berlin, Germany</i>)

15.40 – 15.58	M6	Translation and Psychometric Testing of the Arabic Version of Cognitive and Affective Variable and Physical Activity Instruments Eman Z. Bajamal ¹ , Lorraine B. Robbins ² (¹ King Saud bin Abdulaziz University for Health Sciences Saudi Arabia, ² Michigan State University, USA)
15.58 – 16.16	M7	Long Term Effects of Psychosocial Stimulation on Development of Anemic and Non Anemic Children in Rural Bangladesh Sheikh Jamal Hossain, Fahmida Tofail, Fardina Mehrin, Shirina Aktar, Syed N. Huda, Jena D. Hamadani (<i>International Centre for Diarrhoeal Disease Research, Bangladesh</i>)
16.20 – 16.35	Evening Refreshments	

TECHNICAL SESSION 21: Primary Health care 1 (J)

Friday, 28th July 2017 | 14.10 to 16.20 (The Latitude 1.02 Hall)

Chaired by Dr. Zeynep Kirdi Harbawi (*Istanbul University, Turkey*)

14.10 – 14.28	J1	Strengthening the Public Health Infrastructure in Emergencies Situation towards Healthy Community Gurung RK, Mahat B, Sah SK, Bhatta GK (<i>Adventist Development & Relief Agency, Nepal (ADRA Nepal)</i>)
14.28 – 14.46	J2	Non Communicable Disease Risk Factors at a Workplace in the Philippines: A Screening towards a Healthier Community Andoy-Galvan, J (<i>Taylor's University, Malaysia</i>)
14.46 – 15.04	J3	Primary Health & Public Health Care an Australian Indigenous Health Worker Approach Hoskins JR (<i>Peak Training & Consulting Pty Ltd, Australia</i>)
15.04 – 15.22	J4	A Look at the Real Picture: Study of Awareness about Health Information Management among Primary Level Healthcare Professionals in an Indian District Dola Saha (<i>Manipal University, Manipal, India</i>)
15.22 – 15.40	J5	Analysis of Puskesmas Expenditure in Indonesia in the Era of Health Insurance in Indonesia (Case Study in Kediri City, East Java) Rachmad Suhanda, Fauzan Adima (<i>Airlangga University, Indonesia</i>)
15.40 – 15.58	J6	Transformative Learning on Public Health Research for Next Generation of Public Health Experts in Bangladesh G U Ahsan, Khadija Leena, Mobashera Jahan (<i>North South University, Bangladesh</i>)
15.58 – 16.16	J7	Diagnostic Accuracy of GMHAT-PC Marathi: A Cross Sectional Study in Rural Maharashtra ¹ Tendolkar V. D, ² Behere P. B, ³ Sharma V. K. (¹ Datta Meghe Institute of Medical Sciences (Deemed University), India, ² D.Y. Patil University of Medical Sciences, Kolhapur, ³ Chester University, UK)
16.20 – 16.35	Evening Refreshments	

TECHNICAL SESSION 22: Health Promotion, Education and Hospital Management (N)

Friday, 28th July 2017 | 14.10 to 16.20 (The Latitude 1.03 Hall)

Chaired by Dr. Mohd Hafiz Jaafar (*Universiti Sains Islam Malaysia, Malaysia*)

14.10 – 14.28	N1	Health Promotion Effect on Woman Knowledge Level about Cervical Cancer and Pap Smear in Public Health Center Kendal Kerep Malang Dian Yuliartha Lestari, Gita Sekar Prihanti, Tutut Widya Anggraini (<i>Medical Faculty Of Muhammadiyah Malang University, Indonesia</i>)
14.28 – 14.46	N2	The Influence of Selfcare Group towards Confidence of Lepers in Jeneponto Regency Sapriadi S (<i>Department of Nursing in STIK Famika Makassar, Indonesia</i>)

14.46 – 15.04	N3	Perceived Benefit Change to Self - Screening Breast Cancer Diseases among Young Mother with Health Belief Model Approach Yoyok Bakti Prasetyo, Sri Wahyu Handayani, Ririn Harini (<i>Muhammadiyah University of Malang, Indonesia</i>)
15.04 – 15.22	N4	Effect of Educational Intervention using Mobile Phone on Self-Care Behaviors of Patients with Thalassemia Major Teamur Aghamolaei, Fatemeh Gharaati, Laleh Hassani, Shokroallah Mohsseni (<i>Hormozgan University of Medical Sciences, Iran</i>)
15.22 – 15.40	N5	A Survey of Knowledge, Attitudes, and Practices of Malaria in a Rural Endemic Setting of Kulon Progo, Indonesia: A One Health Approach from PROMOTE Project Jonathan H. Haposan, Intan Esaputri, Nova Y. Prasetyo, Ditha M. Daud, Alif Kurniawan, Halwan F. Bayuanga, Mahardika A. Wijayanti, Noor A. Mahmudah (<i>Universitas Gadjah Mada, Indonesia</i>)
15.40 – 15.58	N6	Self-Rated Assessment of Conflict at Work among Staff Nurses of Tertiary Care Hospital in New Delhi Kaur G, Kumar A, Singh J (<i>Guru Gobind Singh Indraprastha University, India</i>)
15.58 – 16.16	N7	To Assess the Emotional Maturity of Mothers of Cerebral Palsy Children among Rural Area Madhuri Wane, Occupational Therapist, Sandeep Shrivastav (<i>Orthopedics Jawaharlal Nehru Medical College, DMIMS(DU), India</i>)
16.20 – 16.35	Evening Refreshments	

POSTER SESSION 1 (P)

Friday, 28th July 2017 | 14.30 – 15.40

Chaired by Prof. Dr. Hematram Yadav (*MAHSA University, Malaysia*)

14.30 – 14.37	P1	Tackling the Burden of Alcoholism in Southwark Basma Ikram (<i>King's College London, UK</i>)
14.37 – 14.44	P2	Ebola: Emergency Preparedness and Perceived Response of Malaysian Healthcare Providers Kingston Rajiah, Marikannan Maharajan, Sarah Zakiah Binti Samsudin, Tan Choo Lin, Adeline Tan Yen Pei, Audrey Wong San Ying (<i>International Medical University, Malaysia</i>)
14.44 – 14.51	P3	Impact of Mental Health in Government Officials and Farmers after Carcass Disposal in Korea Yun-Jung Yang (<i>Catholic Kwandong University, International St. Mary's Hospital/ Institute for Integrative Medicine, Republic of Korea</i>)
14.51 – 14.58	P4	Smoking in Pregnancy: Prevalence and Trends over the Last 10 Years in Australia Chuah S.C (<i>University of Newcastle, Australia</i>)
14.58 – 15.05	P5	High Body Fat Percentage among Adult Women in Malaysia: The Role of Lifestyle J. Sa'ida Munira, N. Norsham Juliana, S. Ainul Huda (<i>Islamic Science University of Malaysia, Malaysia</i>)
15.05 – 15.12	P6	Development of Stroke Preventive Care Model for Older Persons in a Primary Care Context Sakorn I, Wanapa S. (<i>Khon Kaen University, Thailand</i>)
15.12 – 15.19	P7	Effect of Weight Management Program through Communication Software Application of Mobile Phone and Face-to-Face ^{1,2} Yi-Ting Chan, ¹ Yi-Ling Yang, ¹ Hsiao-Chun Lin, ¹ Chung-Mei Ouyang (¹ National Taiwan University Hospital Hsin-Chu Branch, Taiwan, ² Taipei Medical University, Taiwan)

15.19 – 15.23	P8	Inter-Relation between Three Measures of Health Inequalities in Incidence, Prevalence and Mortality Rates of Cardiovascular Disease Park JH, Ki M, Kang MK (<i>Korea University of Medicine, Republic of Korea</i>)
15.23 – 15.30	P9	Economic Analysis of Household Fuel in India with Pseudo-Panel Technique - Aim to Reduce Indoor Air Pollution Keita Shimmei (<i>Keio University, Japan</i>)
15.30 – 15.37	P10	Evaluating Bio Statistical Competencies for Medical Student: The Benefits of a Biostatistics Centre Development Prihanti Gs (<i>University of Muhammadiyah Malang, Indonesia</i>)

POSTER SESSION 2 (P)

Friday, 28th July 2017 | 14.30 – 15.40

Chaired by Prof. Kumudu Wijewardene (*University of Sri Jayewardenepura, Sri Lanka*)

14.30 – 14.37	P11	Assessment of Microbial Contaminants and Water Quality from Residential Swimming Pools in Ampang District Ismail Z ¹ , Mohamed N.A ¹ , Ramli S ¹ , Isahak I ¹ , Md Ariffin U.K ² (<i>Islamic Science University of Malaysia¹, Ampang Jaya Municipal Council, Malaysia²</i>)
14.37 – 14.44	P12	Improvement of Laboratory Services Quality of Outpatient Installation at Semen Gresik Hospital by Quality Function Deployment (QFD) Method Heru Suswojo (<i>Universitas Airlangga, Indonesia</i>)
14.44 – 14.51	P13	A Study on the Effort of Smoking and Drinking Preventive Education at the Night High School Students in Japan Shinkai. M, Kobayashi. T (<i>Hiroshima University, Japan</i>)
14.51 – 14.58	P14	Contraceptive Switching Pattern among Married Women in East Java Yuliamran, Rita Damayanti, Budi Utomo (<i>University of Indonesia, Indonesia</i>)
14.58 – 15.05	P15	The Effect of Forest Bathing on Psychological and Physiological Functions in Participants with Depressive Tendency Kobayashi, T ¹ , Furuyashiki, A ¹ , Hanaoka, M ¹ , Yabase, K ¹ , Kawahara, D ¹ , Ueoka, H ¹ , Kageyama, M ² , Tabuchi, K ¹ (<i>¹Hiroshima University, Japan, ²Oita University of Nursing and Health Sciences, Japan</i>)
15.05 – 15.12	P16	Judgments Regarding Order and Disorder in Perceptual Organization of Stationery on a Table Manabu Gouko (<i>Tohoku Gakuin University, Japan</i>)
15.12 – 15.19	P17	The Effectiveness of Doktor Muda as Peer Educator: Health Knowledge, Attitude and Practices of Primary School Children in Malaysia Suraiya SM, Siti Nur Farhana H, Md ,Sabtuah MR, Nor Haryati AS, Kamarul Zaman S (<i>Institute of Health Behavioural Research, Malaysia</i>)
15.19 – 15.23	P18	Do Mothers' Authoritative Parenting Style and Mindfulness Affect the Problematic Behaviors of Preschool Children? Yabase, K ¹ , Takase, M ² , Kobayashi, T ¹ (<i>¹Hiroshima University, Japan, ²Yasuda Women's University, Japan</i>)
15.23 – 15.30	P19	Medication Adherence among Diabetics: Are They Comply? Kamarul Zaman S, Suraiya Sm, Md Sabtuah Mr, Nor Haryati As, Nurfarhana H, Norbaidurah H (<i>Institute for Health Behavioural Research, Malaysia</i>)
15.30 – 15.37	P20	Framing of Health Messages: Diabetic Patient's Perspectives Ahmad, Normawati (<i>Institute For Health Behavioral Research, Ministry of Health, Malaysia</i>)

TECHNICAL SESSION 23: Adolescent & Young Adults Health (T)

Friday, 28th July 2017 | 16.35 to 17.50 (Atlanta Ballroom)

Chaired by Dr. Gul Baloch (*Taylor's University, Malaysia*)

16.35 – 16.53	T1	Have the Adolescents be Powerfull in the Implementation Program for Them? Pulung Siswantara, Oedojo Soedirham, Muthmainnah (<i>Universitas Airlangga, Indonesia</i>)
16.53 – 17.11	T2	Analyses of Factors Related to Juvenile Delinquency at Juvenile Court Blitar East Java – Indonesia Tri Anjaswarni, S.Kp. M.Kep. (<i>Universitas Airlangga, Indonesia</i>)
17.11 – 17.29	T3	The Relationship of Self Concept With Medication Adherence to Arv in HIV-Positive Women's Reproductive in Poly Vct Waluyoajati General Hospitals Probolinggo Indonesia Widia Shofa Ilmiah, Mochammad Bagus Qomaruddin (<i>University of Airlangga, Indonesia</i>)
17.29 – 17.47	T4	Association between Hikikomori (Prolonged Social Withdrawal) and Childhood and Present Family Relationship Yong Kim Fong Roseline (Yong R.) (<i>Akita University Graduate School of Medicine, Japan</i>)

TECHNICAL SESSION 24: Metabolic Syndrome (R)

Friday, 28th July 2017 | 16.35 to 17.30 (The Latitude 1.01 Hall)

Chaired by Dr. Girish Prabhu (*Taylor's University, Malaysia*)

16.35 – 16.53	R1	Utilization Study of Anti-Diabetic Agents in a Teaching Hospital of Sikkim and Adherence to Current Standard Treatment Guidelines Sushrut Varun Satpathy, Supratim Datta, Binu Upreti (<i>Sikkim Manipal Institute of Medical Sciences, Gangtok, India</i>)
16.53 – 17.11	R2	Metabolic Syndrome Risk Factors in Employees Faculty of Public Health, University Airlangga Kurnia D Artanti, Santi Martini (<i>Universitas Airlangga, Indonesia</i>)
17.11 – 17.29	R3	Renal Complications in Diabetic Patients H K Darnal, M.D, K Norain, MPath, A J Nur Masyeerah, A S Afira (<i>Mahsa University, Malaysia</i>)

TECHNICAL SESSION 25: Mental Health 2 (M)

Friday, 28th July 2017 | 16.35 to 17.30 (The Latitude 1.02 Hall)

Chaired by Prof (Dr) Vijay Kumar Mehta (*Sikkim Manipal University, India*)

16.35 – 16.53	M8	Social Capital and Mental Health in Indonesia Mohamad Fahmi, Adiatma Siregar, Deni K Sunjaya, Gilang Amarullah, Rahma, Nur Afni Panjaitan (<i>Universitas Padjadjaran, Indonesia</i>)
16.53 – 17.11	M9	The Length of Breastfeeding and Mental Health Status in Indonesia Siregar., AYM, R. Rahma, Panjaitan, N.A, Amarullah, G, Sunjaya, D.K, Fahmi, M (<i>Universitas Padjadjaran, Indonesia</i>)
17.11 – 17.29	M10	The Medical and Non-Medical Costs of Treating Mental Illness in Indonesia Siregar, AYM, Sunjaya, D.K, Remi S.S (<i>Universitas Padjadjaran, Indonesia</i>)

TECHNICAL SESSION 26: Oral Health and Pharmacy (Q)

Friday, 28th July 2017 | 16.35 to 17.15 (The Latitude 1.03 Hall)

Chaired by Prof. Kumudu Wijewardene (*University of Sri Jayewardenepura, Sri Lanka*)

16.35 – 16.53	Q1	Evaluation of Governmental Oral Health - Care Infrastructure in the State of Haryana, India R. Sohi (<i>Sri Sukhmani Dental College and Hospital, India</i>)
---------------	-----------	--

16.53 – 17.11	Q2	A Review of Medication Errors Reported to the Malaysian Medication Error Reporting System (2009-2012) Samsiah Awang ^{1,2} , Noordin Othman ³ , Shazia Jamshed ¹ , Mohamed Azmi Hassali ⁴ , Wan Mohaina Wan Mohamed ⁵ (¹ <i>International Islamic University Malaysia, Malaysia</i> , ² <i>Institute for Health Systems Research, Ministry of Health, Malaysia</i> , ³ <i>Taibah University, KSA</i> , ⁴ <i>Universiti Sains Malaysia, Malaysia</i> , ⁵ <i>National Pharmaceutical Regulatory Agency, Ministry of Health, Malaysia</i>)
---------------	-----------	--

POSTER SESSION 3 (P)

Friday, 28th July 2017 | 16.45 to 17.50

Chaired by Prof. Dr. Hematram Yadav (*MAHSA University, Malaysia*)

16.45 – 16.52	P21	Prevalence of Diabetes Mellitus Type II among Ethnic Population in the Urban Community of Sikkim, India. Binu Upreti (<i>Sikkim Manipal Institute of Medical Sciences, India</i>)
16.52 – 16.59	P22	Human Papillomavirus Vaccine Acceptability and Its Associated Factors among Female Students at a Private Medical University in Kuala Lumpur ¹ Sowmya Ramakrishnappa, ² Purushotham Krishnappa (¹ <i>Mahsa University, Malaysia</i> , ² <i>International Medical University, Malaysia</i>)
16.59 – 17.06	P23	Gender Preference and Desired Family Size in Women Using Long Acting Reversible Contraception in Underserved Population of Sindh, Pakistan: A Cross-Sectional Survey Umair Aslam, Haris Ahmed, Hina Najmi, Lutaf Ali (<i>Sukh Initiative, Aman Health Care Services, Aman Foundation, Pakistan</i>)
17.06 – 17.13	P24	Environmental High Risk Assessment of Total Suspended Particular Exposure to Employee of Pt Semen Padang Aria Gusti, Resi Arifa Yurnal (<i>Andalas University, Indonesia</i>)
17.13 – 17.20	P25	Psychometric Properties of Korean Version of Pulmonary Rehabilitation Adapted Index of Self-Efficacy (PRAISE) for Patients with Chronic Obstructive Pulmonary Disease (COPD) Song. H-Y ¹ , Nam. K. A ² (<i>Yonsei University, South Korea¹</i> , <i>Hallym University, South Korea²</i>)
17.20 – 17.27	P26	Ethnography of Youth Learning Poonthawe, P. & Nuntaboot, K. (<i>Khon Kaen University, Thailand</i>)
17.27 – 17.34	P27	Food Safety: Knowledge, Attitude and Practice among Guru Pendidik Kesihatan in Primary School, Malaysia Md Sabtuah MR, Abdul Hadi I, Kamarul Zaman S, Nor Haryati AS, Siti Nur Farhana H, Suraiya SM (<i>Ministry of Health Malaysia, Malaysia</i>)
17.34 – 17.41	P28	The Effect of an Educational Intervention Based on Health Belief Model on Standard Precautions among Medical Students of Rafsanjan University of Medical Sciences Asadpour Mohammad ¹ , mohseni Mohabbat ² , Mahboubi Mahmoud ³ , Sayadi Ahmadsreza ⁴ , Shabani Ziba ⁵ (¹ <i>Department of Health Services and Health Promotion, School of Health, Rafsanjan University of Medical Sciences, Iran</i> , ² <i>Social Determinant of Health Research Center, Institute for Futures Studies in Health, Kerman University of Medical Sciences, Iran</i> , ³ <i>Ph.D students of Health Education and Promotion, Shahid Sadoughi University of Medical Sciences, Yazd, Iran</i> , ⁴ <i>Department of Nursing psychology, Nursing and Midwifery School, Rafsanjan University of Medical Sciences, Rafsanjan, Iran</i> , ⁵ <i>Department of Internal Medicine, Rafsanjan University of Medical Sciences, Rafsanjan, Iran</i>)
17.41 – 17.48	P29	Medication Error Reporting in Primary Care Settings: A Systematic Review Samsiah Awang ^{1,2} , Noordin Othman ³ , Shazia Jamshed ¹ , Mohamed Azmi Hassali ⁴ (¹ <i>Kuliyah of Pharmacy, International Islamic University Malaysia, Malaysia</i> , ² <i>Institute for Health Systems Research, Ministry of Health, Malaysia</i> , ³ <i>Almadinah Almunawwarah, KSA</i> , ⁴ <i>Universiti Sains Malaysia, Malaysia</i>)

POSTER SESSION 4 (P)

Friday, 28th July 2017 | 16.45 to 17.55

Chaired by Prof. Kumudu Wijewardene (*University of Sri Jayewardenepura, Sri Lanka*)

16.45 – 16.52	P30	Perceived Effectiveness of Pictorial Health Warnings on Tobacco Package in Korea: A Cross-Sectional Study Kim, Mi Young · Lee, Ahn Na · Park, Ah Hyun · Lee, Joung-Eun · Kim, Ji-Hye · Sun, Phil-Ho (<i>National Tobacco Control Center, Korea Health Promotion Institute, Korea</i>)
16.52 – 16.59	P31	Core Adult Tobacco Survey: Baguio City, Philippines 2012 Andoy-Galvan, J (<i>Taylor's University, Malaysia</i>)
16.59 – 17.06	P32	Health Care Needs and Health Service Needs for Adolescents Living with HIV Songprakon, S., Siripul, P (<i>Khon Kaen University, Thailand</i>)
17.06 – 17.13	P33	Helicobacter Pylori Infection Estimation in General Population of Lahore Khan MU, Ahmed S, Munir R, Ghafoor A (<i>University of the Punjab, Pakistan</i>)
17.13 – 17.20	P34	Microbiological Examination of Ready-to-Eat Salads in Lahore, Pakistan Khan MU ¹ , Rehman R ² , Sidra S ² (¹ <i>University of the Punjab, Pakistan</i> , ² <i>University of Health Sciences, Pakistan</i>)
17.20 – 17.27	P35	Take Heed! Antinuclear Antibodies (IgG) Existence in General Population Khan MU ¹ , Ghafoor A ² , Tahir M ² (¹ <i>University of the Punjab, Pakistan</i> , ² <i>AL-RAZI Health Care Centre, Pakistan</i>)
17.27 – 17.34	P36	Comprehensive Evaluation of Vitamin D Status in General Population of Lahore Muhammad Umer Khan ¹ , Ghafoor A ² , Tahir M ² (¹ <i>University of The Punjab, Pakistan</i> , ² <i>AL-RAZI Health Care Centre, Pakistan</i>)
17.34 – 17.41	P37	Modelling Pakistan Health System Performance Domains and Effective Implementation of 18th Amendment Saad Ahmed Khan, Amaila Fazal (<i>Dadabhoy Institute of Higher Education, Pakistan</i>)
17.41 – 17.48	P38	Effectiveness of a Multi-Level and Context-Specific Intervention Designed to Improve Tb Treatment Adherence and Retention into Care among Migrant Mineworkers with Tb in South African Gold Mines: A Randomised Controlled Trial M Muzigaba (<i>Enhancing Care Foundation & Durban University of Technology, South Africa</i>)
17.48 – 17.55	P39	Health Service Related Factors and The Utilization of First Week Postnatal Care by Mothers Attending Under-Five Clinics in Iringa, Tanzania Maureen Sylvia Kusiima, Frida Mliga Kingazi And Busiri Julius (<i>Uganda Christian University, Uganda</i>)

Thursday, 28th July 2017 | 18.00 to 19.00 (Atlanta Ballroom)

18.00 – 19.00	Student Gathering
---------------	--------------------------

Students' Gathering

The International Conference on Public Health (ICOPH 2017) will host a Students' Gathering aiming the Student Participants of the Conference with the objective of developing the network among students who represent different nationalities and backgrounds to share, experience and enjoy working with their Conference peers. Exciting games and activities are lined up to make the day a pleasant one with moments to cherish and memories to be remembered.

Date : - 28th July 2017

Time : - 06.00 p.m. - 07.00 p.m.

Agenda

6.00 pm – 6.03 pm - Introduction

6.03 pm – 6.08 pm - Inspirational Video

6.08 pm – 6.20 pm - Game 1 (Individual) – “Never Have I ever”

6.20 pm – 6.30 pm - Game 2 (Group) – “Tallest Tower”

6.30 pm – 6.35 pm - Game 3 (Group) – “General Knowledge Quiz”

6.35 pm – 6.55 pm - Discussion (You can share your experiences, strengths and the challenges you face in your academic life)

6.55 pm – 7.00 pm - Conclusion

(Winners will be awarded with Special Gifts)



DAY 03

Saturday, 29th July, 2017

Coming up in line as Special Features: -

- Conference Chair Workshop
- Awarding Ceremony

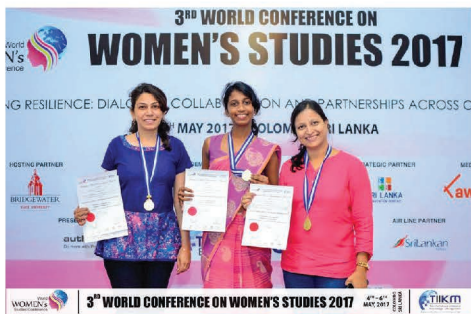



INTERNATIONAL CONFERENCE ON NUTRITIONAL AND GENETIC EPIDEMIOLOGY

"The Interplay between Nutrition and the Genome"

06th -07th November 2017
Colombo, Sri Lanka

CONFERENCE TRACKS

Nutrigenetics and metabolic diseases
Nutrigenetics and cardiovascular diseases
Diet and the microbiome
Multi-omics Approaches
Epigenetics
Cancer and Aging
Translational Aspects and the Future
of Medicine
Personalized Nutrition
Functional Foods
Immunogenetics

REGISTER NOW

www.nutritionconference.co



World Disability & Rehabilitation Conference 2017

2ND WORLD DISABILITY AND REHABILITATION CONFERENCE

*"A Spectrum of Opportunities: Overcoming
Disability & Its Challenges"*

16th -17th November 2017
Colombo, Sri Lanka

CONFERENCE TRACKS

Advocacy, Public Policy and People with Disabilities
Rehabilitation of people with Disabilities
Disability Management
Assistive Technology/Universal Design and
Emerging Technologies for Disability
Ethics, clinical and technical perspective in
Rehabilitation and Disability
Disability Inclusion, Community and
Disability Service
Inclusive Education and Integration
Employability of People with Disabilities
Disability Legal Services: Fighting discrimination
Disability and Sports: A platform for
development and inclusion

REGISTER NOW

www.disabilityconference.co

TECHNICAL SESSION 27: Preventive Health 3 (E)

Saturday, 29th July 2017 | 09.00 to 10.30 (Atlanta Ballroom)

Chaired by Assoc. Prof. Nurjahan Mohd Ibrahim (*Taylor's University, Malaysia*)

09.00 – 09.18	E10	KAP Study on Hygiene and Sanitation in a Selected Rural Area of Bangladesh Hossain SM, S Huq, Hossain MM, Ibne Mahmud AI, Ara U (<i>Northern University Bangladesh, Bangladesh</i>)
09.18 – 09.36	E11	Knowledge, Attitude and Practice of Cervical Cancer Prevention among Women Residing in an Urban Slum in Lagos, South West, Nigeria Olubodun T, Odukoya O.O, Balogun M.R. (<i>Lagos University Teaching Hospital, Nigeria</i>)
09.36 – 09.54	E12	The Missense C.1169 G>A Mutation in CYP1B1 Causes Primary Congenital Glaucoma Khan MU ¹ , Kaul H ² , Rehman R ² , Mahmood S ² (¹ <i>University of the Punjab, Pakistan</i> , ² <i>University of Health Sciences, Pakistan</i>)
09.54 – 10.12	E13	The Association between Tuberculosis Stigma and the Implementation of Diagnosis Procedure on Tuberculosis Screening Program in Denpasar, Bali, Indonesia IWG Artawan Eka Putra ^{1,2} , PAS Astuti ² , IMK Duana ² , IK Suarjana ² , KH Mulyawan ² , NMD Kurniasari ² , IBG Ekaputra ³ , A Probandari ⁴ , CU Wahyuni ⁵ (^{1,4} <i>Airlangga University, Indonesia</i> , ² <i>Udayana University, Indonesia</i> , ³ <i>Denpasar Health office</i> , ⁵ <i>Universitas Sebelas Maret, Indonesia</i>)
10.12 – 10.30	E14	Drinkable Tap Water: Acceptance and Its Influential Factors in Bangkok Residents, Thailand Tiyanun, E ¹ , Harncharoen, K ¹ , Siri, S ¹ , Srisuphanunt, M ² (¹ <i>Mahidol University, Thailand</i> , ² <i>Western University, Thailand</i>)
10.30 – 10.50	Morning Refreshments	

TECHNICAL SESSION 28: Nutrition 2 (H)

Saturday, 29th July 2017 | 09.00 to 10.30 (The Latitude 1.01 Hall)

Chaired by Prof. Dr. Hematram Yadav (*MAHSA University, Malaysia*)

09.00 – 09.18	H6	Rice-Based Farm Households' Diet Quality and Diversity: The Case of Central Luzon, Philippines Abilgos - Ramos RG, Ballesteros JF (<i>Philippine Rice Research Institute, Philippines</i>)
09.18 – 09.36	H7	Evaluation of Iron Supplementation Program for Pregnant Women in Gunungkidul, Indonesia, 2015 Gaby G. Langi ¹ , R. A. Ahmad ¹ , S. Raharto ² (¹ <i>Universitas Gadjah Mada, Indonesia</i> , ² <i>Gunungkidul District Health office, Indonesia</i>)
09.36 – 09.54	H8	Riding on the Health Trend: A Market-to-Lab Rice-Based Food Product Development Ballesteros, J. F, Abilgos-Ramos, R.G. (<i>Philippine Rice Research Institute, Philippines</i>)
09.54 – 10.12	H9	Nutritional Assessment of Adolescents and Its Determinant Co Factors "Sugar Sweetened Beverage Consumption - Silent Cause behind Imbalanced Weight Status among Adolescents" Bardhar Pallavi, Wason Neelam (<i>Jai Narain Vyas University, India</i>)
10.12 – 10.30	H10	Consumption Pattern of Omega - 3 among Pregnant Mothers Normina binti Ahmad Bustami, Jeevananthan GT, Thiagarajah S, Tan CK, Tan ESS, Amini F, Seghayat MS (<i>UCSI University, Malaysia</i>)
10.30 – 10.50	Morning Refreshments	

TECHNICAL SESSION 29: Mental Health 3 (M)

Saturday, 29th July 2017 | 09.00 to 10.30 (The Latitude 1.02 Hall)

Chaired by Prof. Dr. Hari Kumar Darnal (*Mahsa University, Malaysia*)

09.00 – 09.18	M11	Burden Caregivers of Patients with Mental Illness in Ponorogo Sugeng Mashudi (<i>Muhammadiyah University of Ponorogo, Indonesia</i>)
09.18 – 09.36	M12	Overview of Stress Reaction and Family Experience in the Care of Self Post Mental Disorders Post Stocks M. Suhron (<i>Airlangga University, Indonesia</i>)
09.36 – 09.54	M13	Survey on Medicare Services and Aid (Federal-, State- and County-Levels) to Korean-Americans with A Physical and/or Mental Disability E. Im ¹ , D. Chung ² , G. Lee ³ , S. Park ⁴ , E. Kim ⁵ , S. Chung ⁶ (¹ <i>Southern California University, USA</i> , ² <i>Brown University, USA</i> , ^{3,4} <i>UCLA, USA</i> , ⁵ <i>Tufts University, USA</i> , ⁶ <i>Marymount University, USA</i>)
09.54 – 10.12	M14	Prevalence of and Factors Associated with Burnout among Health Care Professionals in Arab Countries: A Systematic Review I Elbarazi ¹ , T Loney ¹ , S Yousef ² , A Elias ³ (^{1,2} <i>United Arab Emirates University, United Arab Emirates</i> , ³ <i>International Medical University, Malaysia</i>)
10.12 – 10.30	M15	Relationship between Impulse Control and Mental Pain among Young Adults Studying in Health Courses Sarode R.D ¹ , Khubalkar R ² (¹ <i>Datta Meghe Institute of Medical Sciences (Deemed University), Jawaharlal Nehru Medical College, India</i> , ² <i>Rashtrasant Tukdoji Maharaj Nagpur University, India</i>)
10.30 – 10.50	Morning Refreshments	

TECHNICAL SESSION 30: Clinical Medicine 1 (Y)

Saturday, 29th July 2017 | 09.00 to 10.30 (The Latitude 1.03 Hall)

Chaired by Dr. Girish Prabhu (*Taylor's University, Malaysia*)

09.00 – 09.18	Y1	Hypertensive Patients and Doctors Perception about Hypertension and Lifestyle Recommendations in Urban areas of Pakistan - A Qualitative Study Qurrat Ul Ain, W. J. Wills, A. M. Dickinson (<i>University of Hertfordshire, UK</i>)
09.18 – 09.36	Y2	The Impact of Acne Vulgaris on Quality of Life in Adult Patients N. Mundraje ^{1,2} , C.K. Tan ¹ , C.K. Lee ³ , N. Rehman ⁴ , Normina A.B. ¹ , M.S. Seghayat ¹ , F. Amini ¹ , Thiagarajah S. ¹ , E.S.S. Tan ¹ (¹ <i>UCSI University, Malaysia</i> , ² <i>Klinik Mediwave, Malaysia</i> , ³ <i>pantai Hospital Cheras, Malaysia</i> , ⁴ <i>Wahat Alshifa Polyclinics, Saudi Arabia</i>)
09.36 – 09.54	Y3	Epidemiology of Post - Operative Orthopaedics Implant infection and Antibiotics Sensitivity Pattern in a Tertiary Care Hospital in Delhi Kumar A, Singh J, Kaur G (<i>Guru Gobind Singh Indraprastha University, Indonesia</i>)
09.54 – 10.12	Y4	Factors Affecting Blood Donation among Selected Sites in Manila, Philippines Soriano, GP ^{1,2} , Aquino, MGB ^{1,2} (¹ <i>De La Salle Health Sciences Institute, Philippines</i> , ² <i>Centro Escolar University, Philippines</i>)
10.12 – 10.30	Y5	Prevalence of Anabolic Steroids Abuse and Awareness of Its Effects in Male Athletes in Bandar Abbas, Iran Mdani A, Aghamolaei T, Davoodi S H, Madani SH, Safa P (<i>Hormozgan University of Medical Sciences, Iran</i>)
10.30 – 10.50	Morning Refreshments	

TECHNICAL SESSION 31: Student's Session 2 (Undergraduates) (S)

Saturday, 29th July 2017 | 09.00 to 10.30 (The Arcadia 1 Hall)

Chaired by Prof. Dr. Rusli Bin Nordin (*Monash University, Malaysia*)

09.00 – 09.18	S7	The Influence of Socio - Cultural Factors on Early Marriage in Cipacing Village, Jatinangor Sub - District, Sumedang District, West Java-Indonesia Rini Meiandayati, Sefita Aryuti Nirmala, Didah, Lili Puspita Rahayu(<i>Universitas Indonesia, Indonesia</i>)
09.18 – 09.36	S8	Difference of Knowledge and Behavior between Pregnant Woman Who Attend and Not Attend Antenatal Class Program in Maintenance of Pregnancy and Childbirth Preparation at Mekargalih In Jatinangor Sumedang 2014 Sela Fasya, Sefita Aryuti Nirmala, Didah (<i>University of Indonesia, Indonesia</i>)
09.36 – 09.54	S9	“They are Not Friendly at All”: The Influence of Health Care Workers in Adolescent Sexual and Reproductive Health Coetzee, G. K (<i>University of Kwazulu-Natal, South Africa</i>)
09.54 – 10.12	S10	The Empowering Elderly of Education Accompaniment to Reduce Disorder and Abundant Intellectual Depression Ahmad Ilham Nur Rahmaan (<i>University of Jember, Indonesia</i>)
10.12 – 10.30	S11	DRAQONS : Code Blue Radiofrequency Identification Card - Activated System Nurul Fadhillah, Hartono, Sarah E. Bucika, Mona I. Putriani, Fadel Muhammad, Yose R. Ilhami (<i>Andalas University, Indonesia</i>)
10.30 – 10.50	Morning Refreshments	

TECHNICAL SESSION 32: Primary Health Care 2 (J)

Saturday, 29th July 2017 | 10.50 to 12.20 (Atlanta Ballroom)

Chaired by Dr. Umesh Bindal (*Taylor's University, Malaysia*)

10.50 – 11.08	J8	Diabetes Knowledge, Health Beliefs and Health Behavior among High-Risk Community of Type 2 Diabetes in Balinese Rural Area, Indonesia Asril, NM, Tabuchi, K, Kobayashi, T (<i>Hiroshima University, Japan</i>)
11.08 – 11.26	J9	Barangay (Village) Health Board Assemblies: A Powerful Strategy to Engage Rural Communities towards Enhanced Participation and Change Laruan, LMA Fermin, ME, Mating, MM, Victorino, AA, Madino, LG (<i>Rural Health Unit, Kapangan Local Government Unit, Philippines</i>)
11.26 – 11.44	J10	Demand Analysis of Osing Community for First Level Health Facility Services at Program of the National Health Insurance Nuryadi, Artawan Eka Putra, Iwg (<i>University of Airlangga, Philippines</i>)
11.44 – 12.02	J11	Strengthening Public Health Services through Evidence - Based Practices for Saving Maternal Lives in Remote Tribal Area in India Archana Joshi, Akash Kumar Lal, Harshada Bhalerao (<i>Public Health Training Institute, Deepak Foundation, India</i>)
12.02 – 12.20	J12	The Integrated Model of Community Based Public Health Surveillance Arief Hargono, Kurnia Dwi Artanti (<i>Universitas Airlangga, Indonesia</i>)

TECHNICAL SESSION 33: Sociology and Health (V)

Saturday, 29th July 2017 | 10.50 to 12.40 (The Latitude 1.01 Hall)

Chaired by Dr. Zeynep Kirdi Harbawi (*Istanbul University, Turkey*)

10.50 – 11.08	V1	Accuracy Comparison of Anthropometric Formulas of Height Estimation Based on Several Long - Bones Measurement in Deutro - Malay Ethnic ACN Marchianti, LS Arum AHR Ainia (<i>University of Jember, Indonesia</i>)
11.08 – 11.26	V2	Seven Dimensions of Learning Culture: Enhancing Public Health Practice through Formal Learning Ira Nurmala (<i>Universitas Airlangga, Indonesia</i>)
11.26 – 11.44	V3	Role of The Institution of Religion on Lifestyle and Health Behaviour: A Study of Sikhism in Malaysia Baloch Gul Muhammad (<i>Taylor's University, Malaysia</i>)
11.44 – 12.02	V4	Culture of Care and Health Concept of Postpartum Agustina A. Seran (<i>Health Polytechnic Kupang, Indonesia</i>)
12.02 – 12.20	V5	The Effect of Play Therapy Using Constructive Play Method toward Socialization Skill Improvement of Children with Mental Retardation Qamila Anindita, Yulis Setiya Dewi, Hanik Endang Nihayati (<i>Universitas Airlangga, Indonesia</i>)
12.20 – 12.38	V6	Contested <i>Hijra</i> Identities in Bangladesh Khadija Leena (<i>North South University, Bangladesh</i>)

TECHNICAL SESSION 34: Young Adults and Elderly (Z)

Saturday, 29th July 2017 | 10.50 to 12.40 (The Latitude 1.02 Hall)

Chaired by Dr. Mohd Hafiz Jaafar (*Universiti Sains Islam Malaysia, Malaysia*)

10.50 – 11.08	Z1	Construction and Validation of an Active Ageing Awareness Questionnaire Bahuri N.H.A., Said M.A., Su T.T. (<i>University of Malaya, Malaysia</i>)
11.08 – 11.26	Z2	Functional Impairments of Elderly in Rural Areas of East Sikkim, India: Cross-Sectional Study Frieda Bokali P Engheepi, V K Mehta, Nikita Joshi Sonowal (<i>Sikkim Manipal University, India</i>)
11.26 – 11.44	Z3	Relationship of Demographic Characteristics, Elderly Posyandu Membership, Organization Activities with Ability of Daily Activity and Instrumental Elderly in Surabaya City Yuly Sulistyorini, Nunik Puspitasari, Windhu Purnomo (<i>Airlangga University, Indonesia</i>)
11.44 – 12.02	Z4	Australian Community Perspectives on Alcohol, Smoking, and Cancer: The Legacy of the Successful Tobacco Control Program May N., Elliott J, Braunack-Mayer A (<i>The University of Adelaide, Australia</i>)
12.02 – 12.20	Z5	Quality of Life of Elderly in Rural Areas of East Sikkim, India: Cross Sectional Study Ajoy Daniel Rai, Nikita Joshi Sonowal, Frieda Bokali P Engheepi (<i>Sikkim Manipal University, India</i>)
12.20 – 12.38	Z6	Prevalence and Predictors of Erectile Dysfunction in Adult Male Outpatient Clinic Attendees in Johor Rusli Bin Nordin, Trived Soni, Amrina Kaur, Loh Kean Por, Shashi Miranda (<i>Monash University, Malaysia</i>)

TECHNICAL SESSION 35: Clinical Medicine 2 (Y)

Saturday, 29th July 2017 | 10.50 to 12.02 (The Latitude 1.03 Hall)

Chaired by Dr. Girish Prabhu (*Taylor's University, Malaysia*)

10.50 – 11.08	Y6	Prevalence of Hemoglobinopathies among School Going Adolescents in a Rural Block of Darjeeling District, West Bengal, India Nilanjana Ghosh (<i>North Bengal Medical College, India</i>)
11.08 – 11.26	Y7	Prevalence and Associated Factors of Low-Back Pain, Phantom Limb and Residual Limb Pain in Traumatic Lower Limb Amputees in Kosovo: A Longitudinal Study Teuta OV ¹ , Ariana K ² , Agron V ³ , Ardiana M ¹ , Lumnije HK ¹ (<i>University Clinical Center of Kosovo – Clinic of Physical Medicine and Rehabilitation, Kosovo¹, Prishtina, Public Health Institute, Kosovo², Prishtina; and Primary Health Care Clinic, Kosovo³</i>)
11.26 – 11.44	Y8	Knowledge of Parents Regarding Availability of Pneumococcal Conjugate Vaccine (PCV) in Routine Immunization Program to Prevent Pneumococcal Pneumonia Sharmin Khan Luies ¹ , Md. Tarek Hossain ² , Haribondhu Sarma ¹ (<i>¹Nutrition and Clinical Services Division, ICDDR,B, Bangladesh, James P Grant School of Public Health, ²BRAC University, Bangladesh</i>)
11.44 – 12.02	Y9	Family Support and Adherence of Chemotherapy Program Breast Cancer Patients Ni Ketut Alit Armini (NKA) ¹ , Tiyas Kusumaningrum(TK) ² , Harmaniati(HA) ³ , (<i>^{1,2}Universitas Airlangga, Indonesia, ³Nurse Paractitioner, Graha Amerta dr. Soetomo Hospital Surabaya, Indonesia</i>)

TECHNICAL SESSION 36: Preventive Health 4 (E)

Saturday, 29th July 2017 | 10.50 to 11.45 (The Arcadia 1 Hall)

Chaired by Assoc. Prof Nurjahan Mohd Ibrahim (*Taylor's University, Malaysia*)

10.50 – 11.08	E15	Relationship Family Characteristic on Improvement Nutrition Status in Tangerang District, Banten Province, Indonesia Indah. K, Asri P.S (<i>University of Indonesia, Indonesia</i>)
11.08 – 11.26	E16	Awareness and Prevention Practices Related to Sexually Transmitted Infections among Artisans in the Ashanti Region of Ghana Richmond Owusu ¹ , Serwaa Akoto Bawua ¹ , Kofi Aduo-Adjei ² (<i>¹University of Ghana, Ghana, ²National Research University, Russia</i>)
11.26 – 11.44	E17	Prevalence and Predictors of female Sexual Dysfunction in Adult Married and Sexually Active Female Outpatient Clinic Attendees in Johor Bahru Rusli Bin Nordin, Loh Kean Por, Grace Vaitilingam, Leong Chui Lynn (<i>Monash University, Malaysia</i>)

Conference Closure

Saturday, 29th July 2017 | 12.15 to 13.30 (Atlanta Ballroom)

12.40 – 13.10	Conference Chair Workshop
13.10 – 13.30	Conference Concluding and Awarding Ceremony
	Vote of thanks by Mr. Oshadee Withanawasam (<i>Co-Founder, CEO & Chairman - The International Institute of Knowledge Management (TIKM), Sri Lanka</i>)
13.30 Onwards	Networking Lunch

The 3rd International Conference on Public Health 2017 Post Conference Tour - Kuala Lumpur

Tour Itinerary

- 9.00am: Depart from hotel
- 10.00am: Batu caves temple
- 11.30am: National Monument
- 12pm: KL Twin Towers
- 1.00pm: Lunch/Free and easy (own expense)
- 3.00pm: Central Market Arts & Crafts
- 4.30pm: Depart To the Hotel

30TH JULY 2017

Per person rate US \$75

for the Reservations please contact



0094 765 603 737

geeshan@globeenjoy.com

CENTRAL MARKET
SINCE 1888

CONTACT THE ORGANIZING COMMITTEE FOR MORE INFORMATION



Logistic, Accommodation and Tour

Contact : Geeshan Rajapaksha | Hotline: +94 113 024 349 | TP : +94 76 560 3737

E-Mail : geeshan@globeenjoy.com



ORGANIZED BY



CO - HOSTING PARTNERS



ACADEMIC PARTNERS



FACULTY OF MEDICAL SCIENCES
UNIVERSITY OF SRI JAYEWARDENEPURA



SMIMS SIKKIM
MANIPAL UNIVERSITY
SIKKIM MANIPAL INSTITUTE OF MEDICAL SCIENCES



MONASH
University



MEDIA PARTNER



TOUR & ACCOMMODATION PARTNER



EVENT PARTNER



TIKM WILL PUBLISH YOUR FULL PAPER, ACCEPTED THROUGH A DOUBLE BLIND REVIEWED PROCESS, AND FOR FREE OF CHARGE

NO Publication Fee
Article Processing Fee
Author Fee

Get Your Full Papers **Published**

Your Opportunity to publish your paper in the ICOPH 17 Conference Proceedings

All accepted full papers will be published electronically with ISSN (2424-6735) in proceedings with a DOI Number (DOI prefix-10.17501).

We submit the proceedings to be indexed in the

- Thomson Reuters
- SCOPUS
- Mendeley
- Google scholar
- CiteULike
- Cross ref



All full papers in the Conference Proceedings will be indexed in **CABI**. CABI is a leading global publisher producing key scientific publications where you get instant access to over 8.5 million records with over 380,000 abstracts added each year.



Past Conference Proceedings

http://tiikm.com/publication/ICOPH_2016_conference_proceedings.pdf

http://tiikm.com/publication/ICOPH_2015_Proceeding_Book.pdf

Journal Decision Making

Getting it right at the 1st time

Read the instructions for authors

Always use the format or the template provided by the journal

Avoid and check for plagiarism

Submit your article to a journal one at a time

**Send Your Full Papers
on or before 17th of August 2017
to publication@tiikm.com**



Get Your Full Papers Published in ICOPH Supporting Journals

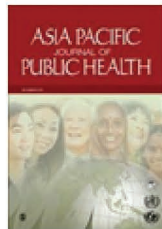

Asia Pacific Journal of Public Health

ISSN: 10105395

Editor I Chief: Wah Yun Low,
University of Malaya,
Kuala Lumpur, Malaysia
5-Year Impact Factor: 1.138

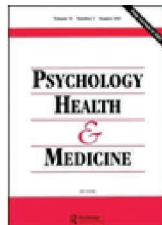

Psychology, Health & Medicine

Print ISSN: 1354-8506

Online ISSN: 1465-3966

Editor: Professor Lorraine Sherr - Royal Free and
University College Medical School, London, UK
Impact Factor: 1.347

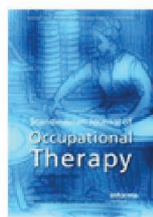

Scandinavian Journal of Occupational Therapy

Editor-in-Chief: Anita Björklund - Jönköping,
Sweden

Print ISSN :1103-8128

Online ISSN :1651-2014

Impact factor (2015): 0.957

Ask these questions when choosing a journal

What is the aim and scope?
Who is the publisher?
What is the peer review process?
What is the impact factor?
Is it print, online or both?
Who is the audience?
What is the submission process?
Does the journal have open access?

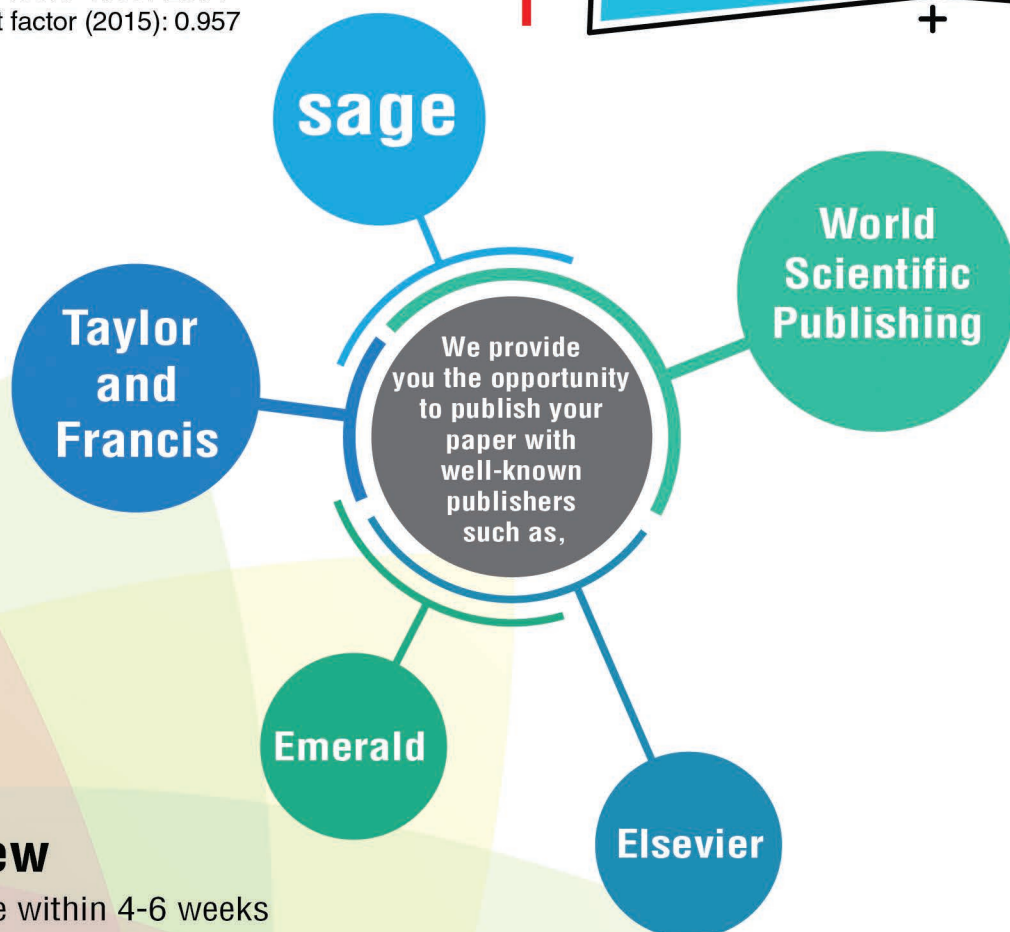

Peer Review

Typically complete within 4-6 weeks

Types

Single blind: names of reviewers are not revealed to authors

Double blind: names of reviewers and authors are not revealed to each other

Open peer review: names of authors and reviewers are revealed to each other

Contact TIKM PUBLICATIONS

If you have a query regarding publications try our FAQ or send an email to publication@tiikm.com

Tel :- 0094 11 3098521/2
Email: publication@tiikm.com

Fax :- 0094 11 2835571
Visit us on: www.tiikm.com

Visit for More Information

<http://publichealthconference.co/publications/> <http://publichealthconference.co/>



WANT TO BE A MEMBER OF THE BIGGEST PUBLIC HEALTH PLATFORM ???

“ IF YOU HAVE KNOWLEDGE, LET OTHERS LIGHT THEIR CANDLES AT IT ”



PARTNER WITH US

WE OFFER

- Complimentary Registrations and Special Discount Rates
- Promotional space (Stalls) in the conference premises
- Paper presentation opportunities
- Opportunities to be a part of the scientific committee
- Opportunities to be session chairs/ evaluation panel members
- Free Publication Opportunities
- Recognition in Prestigious Public Health Industry

**COLLABORATE WITH US BY BEING A HOSTING/ ACADEMIC/ STRATEGIC
PARTNER OF ICOPH 2018**

Get in touch with us now,

Maheesha Dilshani

Phone: +94 78 397 9446

Email: maheesha@tiikm.com

Austin Joseph

Phone: +94 77 398 0659

Email: austin@tiikm.com

THANK YOU

FOR BEING A PART OF



3RD INTERNATIONAL CONFERENCE ON
PUBLIC HEALTH

SEE YOU AT ICOPH 2018
19th - 21st July 2018
Bangkok, Thailand

UPCOMING IN 2017



THE 4TH INTERNATIONAL CONFERENCE ON FISHERIES AND AQUACULTURE

AUGUST 24TH – 25TH 2017 | COLOMBO, SRI LANKA
www.aquaconference.com



THE INTERNATIONAL CONFERENCE ON FUTURES OF MEDIA

OCTOBER 10TH – 11TH 2017 | COLOMBO, SRI LANKA
www.futuremediaconference.com



THE 4TH INTERNATIONAL CONFERENCE ON AGRICULTURE AND FORESTRY

AUGUST 24TH – 25TH 2017 | COLOMBO, SRI LANKA
www.agroconference.com



THE INTERNATIONAL CONFERENCE ON GLOBAL EDUCATION AND E – LEARNING

OCTOBER 10TH – 11TH 2017 | COLOMBO, SRI LANKA
www.educonference.co



THE 4TH INTERNATIONAL CONFERENCE ON ARTS AND HUMANITIES

SEPTEMBER 21ST - 22ND 2017 | COLOMBO, SRI LANKA
www.fineartsconference.com



THE 5TH INTERNATIONAL CONFERENCE ON HOSPITALITY AND TOURISM MANAGEMENT

OCTOBER 17TH – 18TH 2017 | COLOMBO, SRI LANKA
www.tourismconference.co



THE 4TH INTERNATIONAL CONFERENCE ON SOCIAL SCIENCES

SEPTEMBER 21ST, 22ND 2017 | COLOMBO, SRI LANKA
www.thesocialstudies.co



THE 4TH INTERNATIONAL CONFERENCE ON POVERTY AND SUSTAINABLE DEVELOPMENT

DECEMBER 05TH - 06TH 2017 | COLOMBO, SRI LANKA
www.povertyconferences.com



THE 4TH INTERNATIONAL CONFERENCE ON NANOSCIENCE AND NANOTECHNOLOGY

DECEMBER 14TH - 15TH 2017 | COLOMBO, SRI LANKA
www.nanoconference.co

